

MARINE VALVE PRODUCTS CATALOGUE



**QINGDAO HISEA MACHINERY
EQUIPMENT CO., LTD.**

QINGDAO, CHINA

BRIEF INTRODUCTION

QINGDAO HISEA MACHINERY EQUIPEMENT CO., LTD and QINGDAO HISEA MARINE VALVE MANUFACTURING CO., LTD are one of the professional manufacturer and exporter of marine valves, air vent head, and butterfly valves in Qingdao, China. We mainly produce JIS marine valve, DIN marine valves, GB/T marine valves, as well as air vent head. We supply full range of marine globe valve, angle valve, SDNR valve, check valves, gate valves, hose valves, storm valves, ball valve, strainer and mud box, and butterfly valves etc.

With our reliable quality, competitive price, and first class services, our products are exported to Japan, Korea, Singapore, Indonesia, Malaysia, Thailand, Myanmar, Turkey, Dubai, and all over the world. Our target is to be a world-class ONE-STOP supplier of marine equipments and marine valves, and valve spare parts.

For all the customers and friends from at home and abroad, if you are having trouble in finding a reliable partner in China, QINGDAO HISEA is the one company you can trust on. You are always welcome to visit us at any time for business negotiation.

Qingdao Hisea Machinery Equipment Co., Ltd.

Qingdao Hisea Marine Valve Manufacturing Co., Ltd.

Contact: Mr. Michael Ma

jisvalve@aliyun.com;

Mob: +86 18663963498

Skype: jisvalve

Wechat: +86 18663963498

Facebook: jisvalves

Tel: +86 18661671375

Linkedin: marinevalve

Fax: +86 532 87763163

Web: <https://hiseamarine.en.alibaba.com>

Email: sales@qdhiseamarine.com

Http: www.qdhiseamarine.com

JIS MARINE VALVE

BRONZE GLOBE VALVE

F7301-5K GLOBE VALVE

F7303-16K GLOBE VALVE

Manufactured in accordance to JIS F7400
Flanges as per JIS B2220

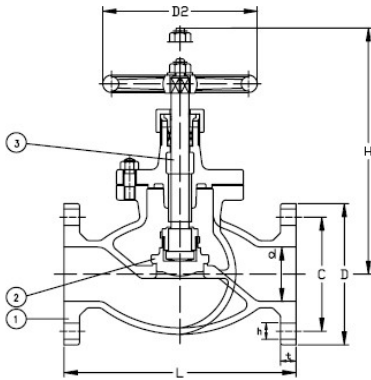
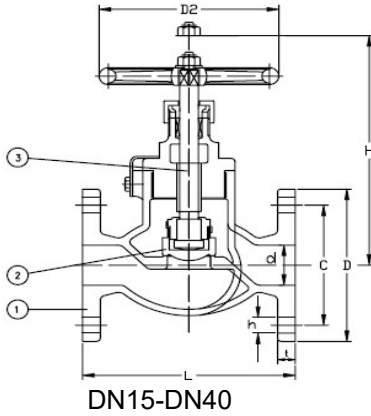

DN50-DN80
Bronze Globe Valve
F7301-JIS 5K
F7303-JIS 16K

Material List		
Part Nr.	Material	
1- Body	Bronze	CAC406
2- Disc	Bronze	CAC406
3- Stem	Brass	C3771BD

Test Pressure MPa			
TYPE	DN	body	seat
5KG-F7301	15-65	1.03	0.76
16KG-F7303	15-80	2.36	1.73

Dimension Table-F7301 JIS 5K								
Size	L	D	C	NO	h	t	H	D2
15	100	80	60	4	12	9	130	80
20	110	85	65	4	12	10	140	100
25	120	95	75	4	12	10	160	125
32	140	115	90	4	15	12	170	125
40	160	120	95	4	15	12	190	140
50	210	130	105	4	15	14	235	140
65	250	155	130	4	15	14	260	160

Dimension Table-F7303 JIS 16K								
Size	L	D	C	NO	h	t	H	D2
15	110	95	70	4	15	12	130	80
20	120	100	75	4	15	14	140	100
25	130	125	90	4	19	14	160	125
32	160	135	100	4	19	16	170	125
40	180	140	105	4	19	16	190	140
50	220	155	120	4	19	20	285	160
65	270	175	140	4	19	22	310	200
80	300	185	150	8	19	22	320	224

JIS MARINE VALVE

BRONZE ANGLE VALVE

F7302-5K ANGLE VALVE

F7304-16K ANGLE VALVE

Manufactured in accordance to JIS F7400
Flanges as per JIS B2220

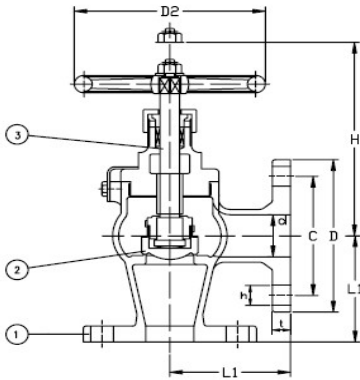

DN15-DN40

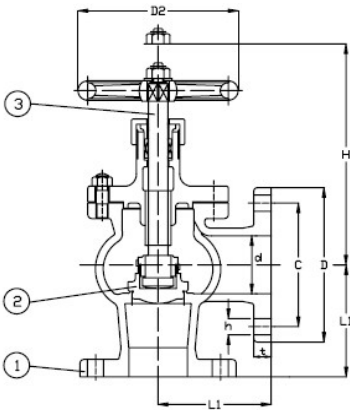

DN50-DN80

Bronze Angle Valve

F7302-JIS 5K

F7304-JIS 16K

Material List		
Part Nr.	Material	
1- Body	Bronze	CAC406
2- Disc	Bronze	CAC406
3- Stem	Brass	C3771BD

Test Pressure MPa			
TYPE	DN	body	seat
5KG-F7302	15-65	1.03	0.76
16KG-F7304	15-80	2.36	1.73

Dimension Table-F7301 JIS 5K								
Size	L	D	C	NO	h	t	H	D2
15	55	80	60	4	12	9	120	80
20	60	85	65	4	12	10	130	100
25	65	95	75	4	12	10	145	125
32	80	115	90	4	15	12	150	125
40	85	120	95	4	15	12	165	140
50	100	130	105	4	15	14	200	160
65	115	155	130	4	15	14	220	180

Dimension Table-F7303 JIS 16K								
Size	L	D	C	NO	h	t	H	D2
15	70	95	70	4	15	12	120	80
20	75	100	75	4	15	14	130	100
25	85	125	90	4	19	14	145	125
32	90	135	100	4	19	16	150	125
40	100	140	105	4	19	16	165	140
50	120	155	120	4	19	20	285	160
65	130	175	140	4	19	22	310	200
80	150	185	150	8	19	22	320	224

JIS MARINE VALVE

BRONZE GLOBE SDNR VALVE

F7351-5K GLOBE SDNR VALVE

F7409-16K GLOBE SDNR VALVE

Manufactured in accordance to JIS F7400
Flanges as per JIS B2220

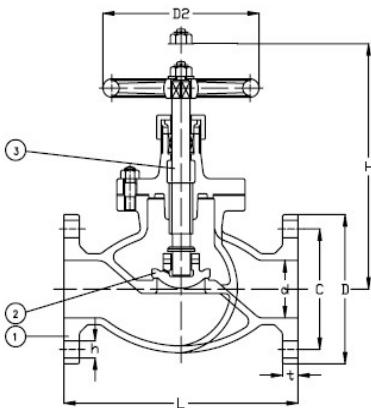
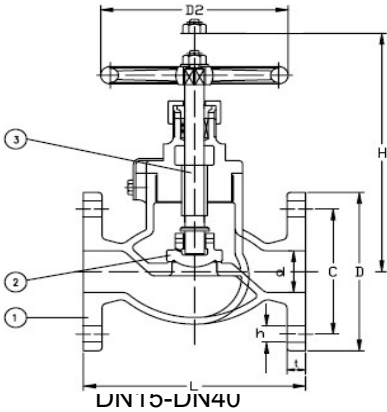

DN50-DN65

Bronze Globe SDNR Valve

F7351-JIS 5K

F7409-JIS 16K

Technical Feature	
Design Standard	JIS F7427-1996
Test Standard	JIS F7400-1996
Flange Standard	JIS B2220-5K
Application	Used for marine pipelines of Fresh Water, air or gas, Fuel Oil, Lub.oil, and Steam at 205°C or below

Material List		
Part Nr.	Material	
1- Body	Bronze	CAC406
2- Disc	Bronze	CAC406
3- Stem	Brass	C3771BD

Test Pressure MPa			
TYPE	DN	body	seat
5KG-F7351	15-65	1.03	0.76
16KG-F7409	15-80	2.36	1.73

Dimension Table-F7351 JIS 5K								
Size	L	D	C	NO	h	t	H	D2
15	100	80	60	4	12	9	130	80
20	110	85	65	4	12	10	140	100
25	120	95	75	4	12	10	160	125
32	140	115	90	4	15	12	170	125
40	160	120	95	4	15	12	190	140
50	210	130	105	4	15	14	235	140
65	250	155	130	4	15	14	260	160
80	280	180	145	4	19	16	280	200

Dimension Table-F7409 JIS 16K								
Size	L	D	C	NO	h	t	H	D2
15	110	95	70	4	15	12	130	80
20	120	100	75	4	15	14	140	100
25	130	125	90	4	19	14	160	125
32	160	135	100	4	19	16	170	125
40	180	140	105	4	19	16	190	140
10K50	210	155	120	4	19	20	233	140
10K65	270	175	140	4	19	22	233	160
16K50	210	155	120	8	19	20	233	140
16K65	270	175	140	8	19	22	233	160

JIS MARINE VALVE

BRONZE ANGLE SDNR VALVE

F7352-5K ANGLE SDNR VALVE

F7410-16K ANGLE SDNR VALVE

Manufactured in accordance to JIS F7400
Flanges as per JIS B2220

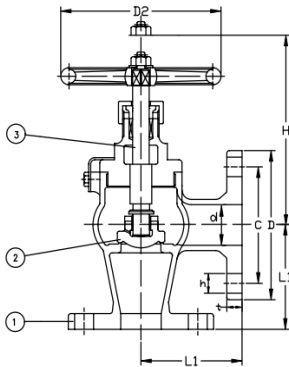

DN15-DN40

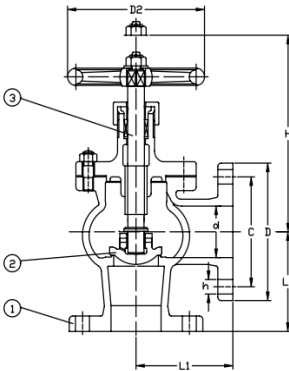

DN50-DN80

Bronze Angle Valve

F7352-JIS 5K

F7310-JIS 16K

Material List		
Part Nr.	Material	
1- Body	Bronze	CAC406
2- Disc	Bronze	CAC406
3- Stem	Brass	C3771BD

Test Pressure MPa			
TYPE	DN	body	seat
5KG-F7302	15-65	1.03	0.76
16KG-F7304	15-80	2.36	1.73

Dimension Table-F7352 JIS 5K								
Size	L	D	C	NO	h	t	H	D2
15	55	80	60	4	12	9	120	80
20	60	85	65	4	12	10	130	100
25	65	95	75	4	12	10	145	125
32	80	115	90	4	15	12	150	125
40	85	120	95	4	15	12	165	140
50	100	130	105	4	15	14	200	160
65	115	155	130	4	15	14	220	180

Dimension Table-F7410 JIS 16K								
Size	L	D	C	NO	h	t	H	D2
15	70	95	70	4	15	12	120	80
20	75	100	75	4	15	14	130	100
25	85	125	90	4	19	14	145	125
32	90	135	100	4	19	16	150	125
40	100	140	105	4	19	16	165	140
50	120	155	120	4	19	20	285	160
65	130	175	140	4	19	22	310	200

JIS MARINE VALVE

Marine Bronze Hose Globe Valve
with Nakajima Coupling

F7334A-5K/10K Hose Globe Valve

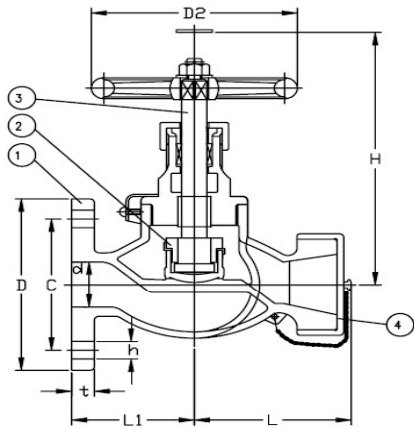

Series F7334A DN15-DN25

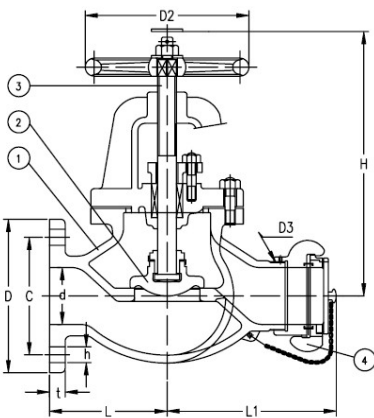

Series F7334A DN40-DN65

Technical Feature	
Design Standard	JIS F7427-1996
Test Standard	JIS F7400-1996
Flange Standard	JIS B2220-5K/10K
Application	Used for marine pipelines of Fresh Water, air or gas, Fuel Oil, Lub.oil, and Steam at 205°C or below

Material List		
Part Nr.	Class S	
1- Body	Bronze	CAC406
3- Disc	Brass	C3771BD
4- Stem	Brass	C3771BD

Hydraulic Inspection MPa[kgf/cm ²]		
Nominal dia.	Body	Seat
5K	1.03[10.5]	0.76[7.7]
10K	2.1[21.0]	1.54[15.4]

Dimension Table											
Size	L	L1	D	C	NO	h	t	H	D2	d3	Weight [kg]
5K15	73	50	80	60	4	12	9	130	80	M42x2	2.51
5K25	78	60	95	75	4	12	10	160	125	M42x2	3.55
5K40	128	80	120	95	4	15	12	190	140	M52x2	6.26
5K50	160	105	130	105	4	15	14	255	160	M64x2	12.9
5K65	195	125	155	130	4	15	14	295	200	M80x2	28.2
10K15	73	55	95	70	4	15	12	130	80	M42x2	2.76
10K25	73	65	125	90	4	19	14	160	125	M42x2	4.15
10K40	133	90	140	105	4	19	16	190	140	M52x2	8.43
10K50	165	110	155	120	4	19	16	270	160	M64x2	15.4
10K65	200	135	175	140	4	19	18	295	200	M80x2	27.8

JIS MARINE VALVE

Marine Bronze Hose Angle Valve
with Nakajima Coupling

F7334B-5K/10K Hose Angle Valve

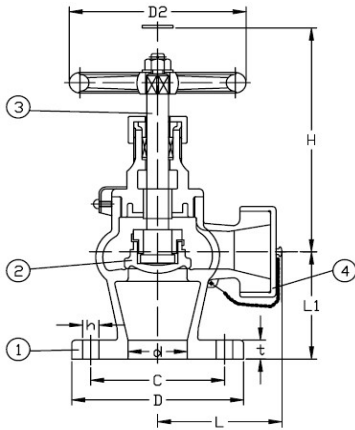

Series F7334B DN15-DN25

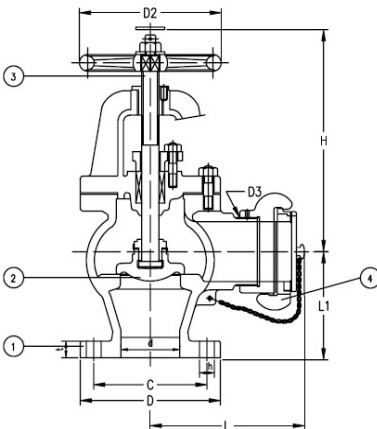

Series F7334B DN40-DN65

Technical Feature	
Design Standard	JIS F7427-1996
Test Standard	JIS F7400-1996
Flange Standard	JIS B2220-5K/10K
Application	Used for marine pipelines of Fresh Water, air or gas, Fuel Oil, Lub.oil, and Steam at 205°C or below

Material List		
Part Nr.	Class S	
1- Body	Bronze	CAC406
3- Disc	Brass	C3771BD
4- Stem	Brass	C3771BD

Hydraulic Inspection MPa[kgf/cm ²]		
Nominal dia.	Body	Seat
5K	1.03[10.5]	0.76[7.7]
10K	2.1[21.0]	1.54[15.4]

Dimension Table											
Size	L	L1	D	C	NO	h	t	H	D2	d3	Weight [kg]
5K15	68	55	80	60	4	12	9	120	80	M42x2	2.41
5K25	78	65	95	75	4	12	10	145	125	M42x2	3.44
5K40	124	85	120	95	4	15	12	165	140	M52x2	5.91
5K50	155	100	130	105	4	15	14	255	160	M64x2	11
5K65	175	115	155	130	4	15	14	295	200	M80x2	16.7
10K15	73	70	95	70	4	15	12	120	80	M42x2	2.72
10K25	83	85	125	90	4	19	14	145	125	M42x2	4.04
10K40	124	100	140	105	4	19	16	165	140	M52x2	8.19
10K50	160	120	155	120	4	19	16	270	160	M64x2	14.3
10K65	180	130	175	140	4	19	19	295	200	M80x2	23

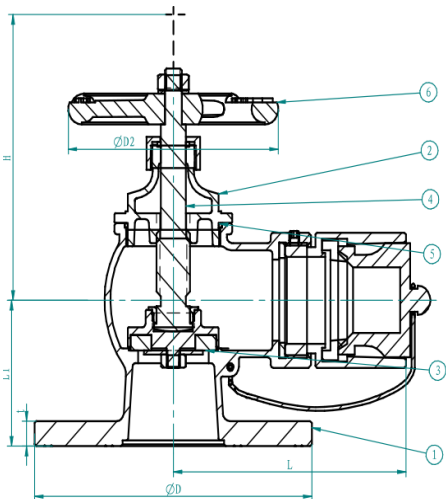

Technical Feature	
Design Standard	JIS F7427-1996
Test Standard	JIS F7400-1996
Flange Standard	JIS B2220-5K
Application	Used for marine pipelines of Fresh Water, air or gas, Fuel Oil, Lub.oil, and Steam at 205°C or below

Material List		
Part Nr.	Material	
1- Body	Bronze or Brass	CAC406 or C3771BD
2- Bonnet	Brass	C3771BD
3- Packing	Brass	NBR
4- Stem	Brass	C3771BD
5- Disc	Brass	C3771BD
6- Handwheel	Brass	FC200

Test Pressure MPa			
TYPE	DN	body	seat
5KG	40-65	1.05	0.77
10KG	40-65	2.1	1.54

Dimension Table- JIS 5K									
Size	DN	L	D	C	NO	h	t	H	D2
1-1/2"	40	112	120	95	4	15	16	118	80
2"	50	139	130	105	4	15	16	142	125
2-1/2"	65	162	155	130	4	15	18	164	140

Dimension Table- JIS 10K									
Size	DN	L	D	C	NO	h	t	H	D2
1-1/2"	40	112	140	105	4	19	16	118	80
2"	50	139	155	120	4	19	16	142	125
2-1/2"	65	162	175	140	4	19	18	164	140

JIS MARINE VALVE

Marine Bronze Non-Rising Stem Gate Valve

F7367-5K Gate Valves

Manufactured in accordance to
JIS F7400
Flanges as per JIS B2220

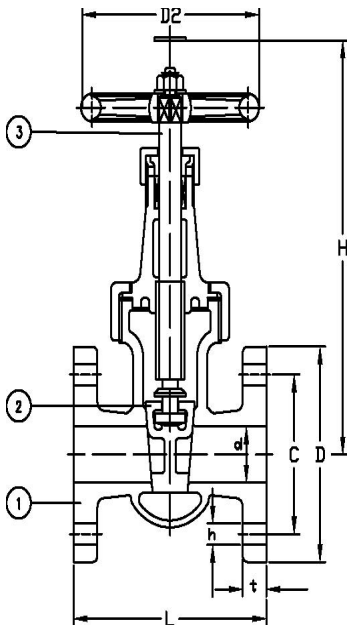

Series F7367

Material List		
Part Nr.	Material	Remark
1- Body	Bronze/Brass	CAC406/C3771BD
2- Disc	Brass	C3771BD
3- Stem	Brass	C3771BD

Hydraulic Inspection[MPa(kgf/cm ²)]	
Nominal Pressure	5K
Body	1.03[10.5]
Seat	1.51[15.4]

Dimension Table									
Size	L	D	C	NO	h	t	H	D2	F7367
									KG
15	90	80	60	4	12	9	175	80	2.29
20	100	85	65	4	12	10	200	100	2.98
25	110	95	75	4	12	10	220	125	4.1
32	130	115	90	4	15	12	250	125	5.79
40	140	120	95	4	15	12	290	140	7.78
50	180	130	105	4	15	16	285	125	14.6
65	190	155	130	4	15	18	330	140	20.6
80	200	180	145	4	19	18	380	160	26.2
100	230	200	165	8	19	20	430	180	38.2
125	250	235	200	8	19	20	495	200	52.1
150	270	265	230	8	19	22	560	224	70.7

JIS MARINE VALVE

BRONZE SWING CHECK VALVE

F7371-5K SWING CHECK VALVE

F7371-10K SWING CHECK VALVE

Technical Feature	
Design Standard	JIS F7427-1996
Test Standard	JIS F7400-1996
Flange Standard	JIS B2220-5K/10K
Application	Used for marine pipelines of Fresh Water, air or gas, Fuel Oil, Lub.oil, and Steam at 205°C or below

Material List		
Part Nr.	Material	
1- Body	Bronze	CAC406
2- Bonnet	Brass	C3771BD
3- Disc	Brass	C3771BD

Test Pressure MPa			
TYPE	DN	body	seat
5K	10-80.	1.03	0.76
10K	15-80	2.1	1.54



Dimension Table-F7371 JIS 5K								
Size	L	D	C	NO	h	t	H	Weight
10	110	75	55	4	12	10	69	2.24
15	110	80	60	4	12	10	69	2.24
20	110	85	65	4	12	10	69	2.24
25	110	95	75	4	12	10	69	2.24
32	130	115	90	4	15	12	79	3.07
40	140	120	95	4	15	12	93	4.34
50	190	130	105	4	15	16	97	9.06
65	220	155	130	4	15	18	119	13.9
80	250	180	145	4	19	18	129	19.1

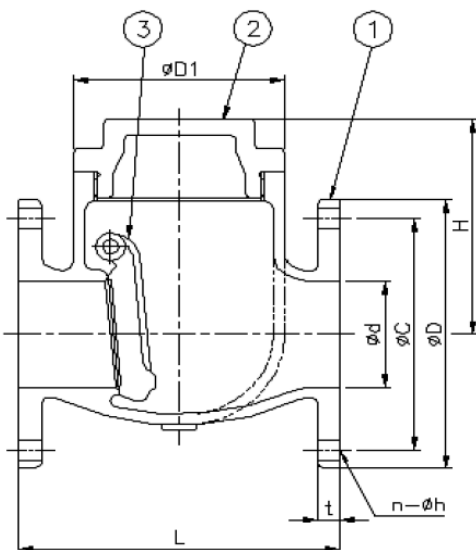

Series F7371 5K/10K

Dimension Table-F7371 JIS 10K								
Size	L	D	C	NO	h	t	H	Weight
15	110	95	70	4	15	10	69	2.24
20	110	100	75	4	15	10	69	2.24
25	110	125	90	4	19	10	69	2.24
32	130	135	100	4	19	12	79	3.07
40	140	140	105	4	19	12	93	4.34
50	210	155	120	4	19	20	97	13.6
65	240	175	140	4	19	22	119	19.6
80	280	185	150	8	19	22	146	22.6

SERIES F7398-JIS 5K and 10K

Bronze Self-Closing Drain Valve

Manufactured in accordance to JIS F7400

Flanges as per JIS B2240 5K&10K

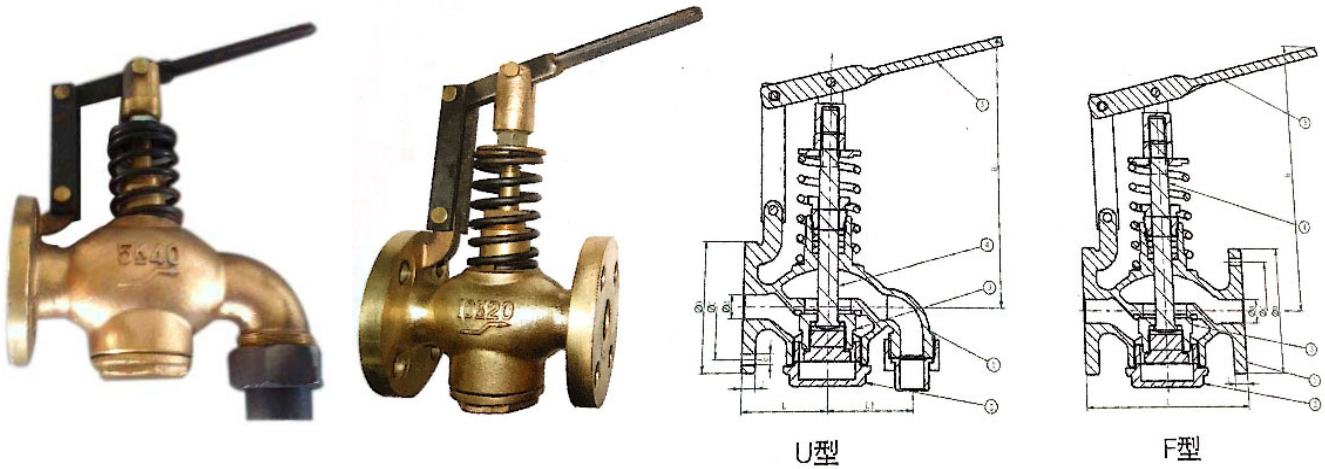

SERIES F7398

Part Nr.	Material	Code
1- Body	Bronze	CAC406
2- Seat	Bronze or Brass	CAC406
3- Disc	Bronze or Brass	CAC406
4- Stem	Brass	C3771BD

Pressure	5K	10K
Body	0.15Mpa	0.15Mpa
Seat	0.11Mpa	0.11Mpa

Size	d	5K						10K						H	weight	
		L	D	C	No	h	t	L	D	C	No	h	t		5K	10K
15	15	55	80	60	4	12	9	55	95	70	4	15	12	175	2.50	2.80
20	20	65	85	65	4	12	10	65	100	75	4	15	14	200	3.87	4.7
25	25	65	90	75	4	12	10	65	125	90	4	19	14	220	3.87	4.7
32	32	90	95	90	4	15	12	90	135	100	4	19	16	250	7.43	8.1
40	40	90	120	95	4	15	12	90	140	105	4	19	16	290	7.43	8.1
50	50	110	130	105	4	15	14	110	155	120	4	19	16	282	12.20	12.4
65	65	135	155	130	4	15	14	135	175	140	4	19	18	302	12.20	12.4

JIS MARINE VALVE

BRONZE FUEL OIL TANK EMERGENCY SHUT-OFF VALVE F7399-5K/10K QUICK CLOSING VALVE

Manufactured in accordance to JIS F7400 , Flanges as per JIS B2220

*Shut-off Operation:
Wire Rope Pull type



Pneumatic Control type

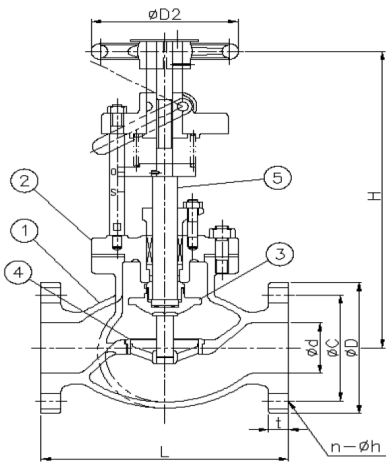
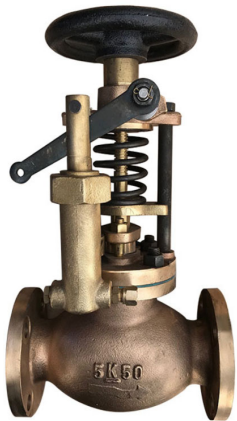

Technical Feature	
Design Standard	JIS F7427-1996
Test Standard	JIS F7400-1996
Flange Standard	JIS B2220-5K
Application	Used for marine pipelines of Fresh Water, air or gas, Fuel Oil, Lub.oil, and Steam at 205°C or below

Material List			
Part Nr.	Material		
1- Body	Bronze		CAC406
2- Disc	Bronze		CAC406
3- Stem	Brass		C3771BD

Test Pressure MPa			
TYPE	DN	body	seat
5KG	15-80	1.03	0.76
10KG	15-80	2.36	1.73

Dimension Table-F7399 JIS 5K											
Size	L	L1	D	C	No	h	t	H	H1	D1	Weight
15	120	55	80	60	4	12	9	260	240	120	7.7
20	120	60	85	65	4	12	10	253	250	120	7.7
25	120	65	95	75	4	12	10	265	250	140	8.8
32	140	80	115	90	4	15	12	265	275	140	13.0
40	160	85	120	95	4	15	12	310	275	140	15.0
50	210	100	130	105	4	15	14	335	305	160	19.5
65	250	115	155	130	4	15	14	395	355	200	30.5
80	280	130	180	145	4	19	14	420	370	200	35.4

Dimension Table-F7399 JIS 10K											
Size	L	L1	D	C	No	h	t	H	H1	D1	Weight
15	130	70	95	70	4	15	12	260	240	120	7.7
20	130	75	100	75	4	15	14	253	250	120	9.2
25	130	85	125	90	4	19	14	265	250	140	16.6
32	160	95	135	100	4	19	16	265	275	140	17.0
40	170	100	140	105	4	19	16	310	275	140	21.8
50	220	120	155	120	4	19	16	335	305	160	32.1
65	270	130	175	140	4	19	18	395	355	200	37.5
80	300	140	185	150	8	19	18	420	370	200	59.2

JIS MARINE VALVE

CLASS 150 BRONZE GLOBE(SDNR) VALVE

B2011-5K BRONZE GLOBE VALVE

B2011-10K BRONZE GLOBE VALVE

Manufactured in accordance to JIS F7400
Flanges as per JIS B2220

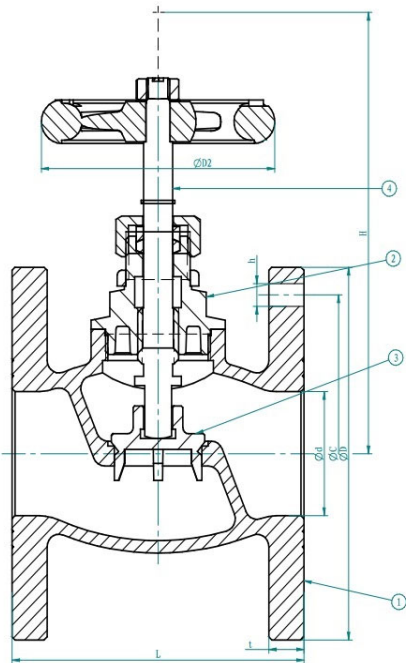

B2011-JIS 5K
B2011-JIS 10K

Material List		
Part Nr.	Material	
1- Body	Bronze	CAC406
2- Disc	Brass	C3771BD
3- Stem	Brass	C3771BD

Test Pressure MPa			
TYPE	DN	body	seat
5KG	15-100	1.05	0.77
10KG	15-100	2.1	1.54

Dimension Table-B2011 JIS 5K									
Size	DN	L	D	C	NO	h	t	H	D2
1/2"	15	60	80	60	4	12	8	77	50
3/4"	20	70	85	65	4	12	9	88	65
1"	25	80	95	75	4	12	10	89	65
1-1/4"	32	100	115	90	4	15	11	110	80
1-1/2"	40	100	120	95	4	15	12	126	80
2"	50	120	130	105	4	15	13	139	100
2-1/2"	65	140	155	130	4	15	13	154	125
3"	80	160	180	145	4	19	16	178	140
4"	100	180	200	165	8	19	16	200	180

Dimension Table-B2011 JIS 10K									
Size	DN	L	D	C	NO	h	t	H	D2
1/2"	15	60	95	70	4	12	8	77	50
3/4"	20	70	100	75	4	15	9	88	65
1"	25	80	125	90	4	19	10	89	65
1-1/4"	32	100	135	100	4	19	11	110	80
1-1/2"	40	100	140	105	4	19	12	126	80
2"	50	120	155	120	4	19	13	139	100
2-1/2"	65	140	175	140	4	19	13	154	125
3"	80	160	185	150	8	19	16	178	140
4"	100	180	210	175	8	19	16	200	180

JIS MARINE VALVE

CLASS 150 BRONZE GATE VALVE

B2026-5K 5K BRONZE GATE VALVE

B2026-10K 5K BRONZE GATE VALVE

Manufactured in accordance to JIS F7400
Flanges as per JIS B2220

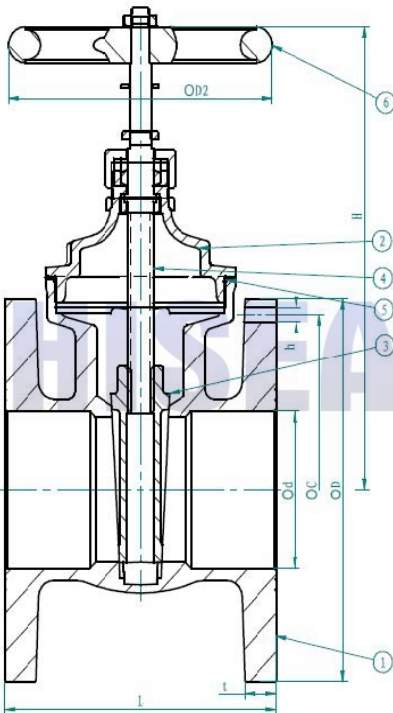
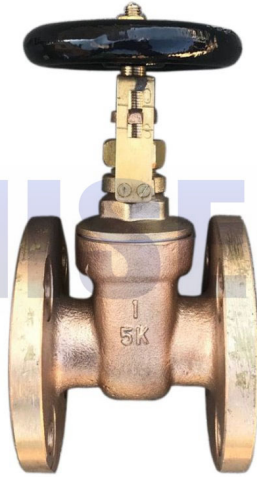

1/2"-4"
B2026-JIS 5K
B2026-JIS 10K

Material List		
Part Nr.	Material	
1- Body	Bronze	CAC406
2- Disc	Brass	C3771BD
3- Stem	Brass	C3771BD

Test Pressure MPa			
TYPE	DN	body	seat
5KG	15-100	1.05	0.77
10KG	15-100	2.1	1.54

Dimension Table-B2026 JIS 5K									
Size	DN	L	D	C	NO	h	t	H	D2
1/2"	15	80	80	60	4	12	9	109	80
3/4"	20	80	85	65	4	12	9	110	80
1"	25	80	95	75	4	12	9	110	80
1-1/4"	32	101	115	90	4	15	11	142	100
1-1/2"	40	101	120	95	4	15	11	142	100
2"	50	116	130	105	4	15	12	167	125
2-1/2"	65	128	155	130	4	15	13	195	125
3"	80	144	180	145	4	19	15	218	140
4"	100	166	200	165	8	19	15	271	180

Dimension Table-B2026 JIS 10K									
Size	DN	L	D	C	NO	h	t	H	D2
1/2"	15	80	95	70	4	12	9	109	80
3/4"	20	80	100	75	4	15	9	110	80
1"	25	80	125	90	4	19	9	110	80
1-1/4"	32	101	135	100	4	19	11	142	100
1-1/2"	40	101	140	105	4	19	11	142	100
2"	50	116	155	120	4	19	12	167	125
2-1/2"	65	128	175	140	4	19	13	195	125
3"	80	144	185	150	8	19	15	218	140
4"	100	166	210	175	8	19	15	271	180

MARINE STRAINER AND MUD BOX

Bronze Y Type Strainer

F7220Q-5K/10K Y TYPE STRAINER

Technical Feature	
Design Standard	JIS F7220-1996
Test Standard	JIS F7400-1996
Flange Standard	JIS B2240-5K/10K
Application	Used for marine pipelines of Fresh Water, air or gas, Fuel Oil, Lub.oil, and Steam at 205°C or below

Material List		
Part Nr.	Material	
1- Body	Bronze	CAC406
2- Cover	Bronze	CAC406
3-	Stainless Steel	SUS304
4-Gasket	Non-asbestos	

Test Pressure MPa		
PN	body	seat
5KG	1.05[10.5]	0.76[7.7]
10KG	2.1[21.0]	1.54[15.4]



Dimension Table-F7220Q JIS 5K							
Size	L	D	C	No	h	t	H
15	165	80	60	4	12	9	86
20	165	85	65	4	12	14	86
25	165	95	75	4	12	14	86
32	170	115	90	4	15	16	106
40	170	120	95	4	15	16	106
50	320	130	105	4	15	16	208
65	350	155	130	4	15	18	250
80	373	180	145	4	19	18	266

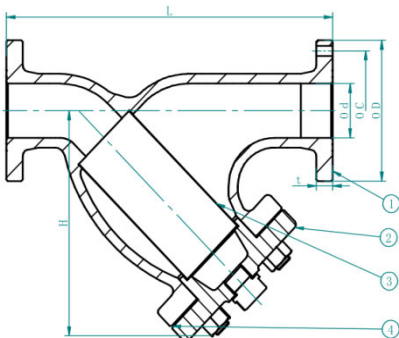

Dimension Table-F7220Q JIS 10K							
Size	L	D	C	No	h	t	H
15	165	95	70	4	15	12	86
20	165	100	75	4	15	14	86
25	165	125	90	4	19	14	86
32	170	135	100	4	19	16	106
40	170	140	105	4	19	16	106
50	320	155	120	4	19	20	208
65	350	175	140	4	19	22	250
80	373	185	150	8	19	22	267

DIN MARINE VALVES

Marine Self-Closing drain valve(spring load valve)U Type

CB/T601-1992 SELF CLOSING DRAIN VALVE



Bronze Material



Cast Steel Material

Technical Feature	
Design Standard	CB/T601-1992
Test Standard	GB/T600-1999
Flange Standard	JIS B2220-5K
Application	Used for marine pipelines of Fuel Oil, Lub.oil, fresh water, and sea water.

Material List	
Part Nr.	Material
1- Body	Bronze/Cast Steel
2- Seat/cover	bronze
3- disc/stem	bronze
4-spring	steel

Test Pressure MPa	
PN	Working pressure
5KG	0.25

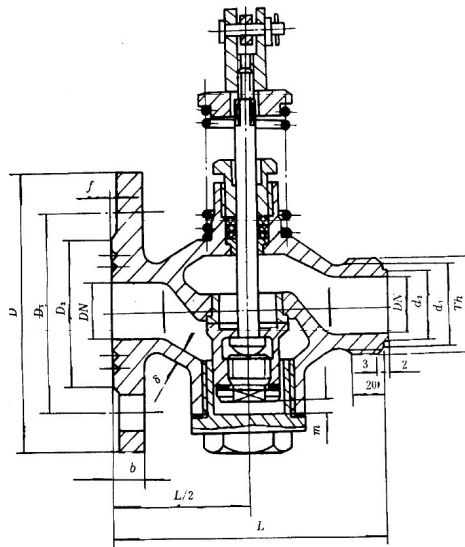
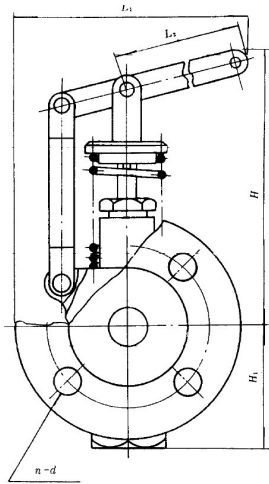

Dimension Table

Size	Structure Dimension					Flange Dimension					Thread joint		weight [kg]
	L	L1	L2	H	H1	D	C	No	h	b	Th	m	
15	130	165	120	146	46	80	60	4	12	12	M30x2	7	1.75
20	160	183	130	168	62	85	65	4	12	12	M42x2	10	3.64
25	160	183	130	168	62	95	75	4	12	14	M42x2	10	3.64
40	200	203	140	195	80	120	95	4	15	16	-	13	6.93

JIS MARINE VALVE

Marine Cast Iron Globe Valve

Marine Cast Iron Globe SDNR Valve

F7305 -5K Globe Valve

F7353-5K Globe SDNR Valve

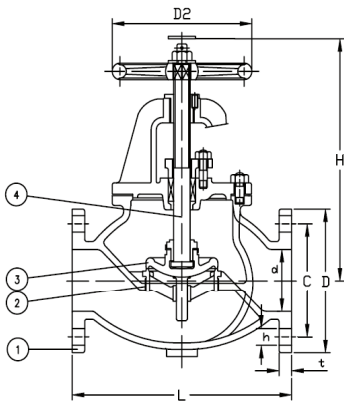

Series F7305

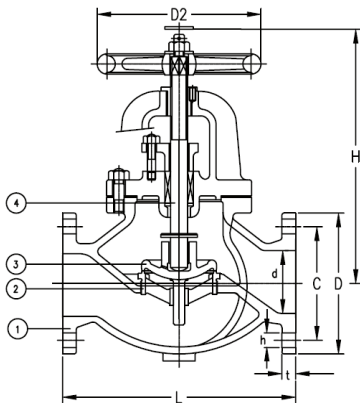

Series F7353(SDNR)

Technical Feature	
Design Standard	JIS F7426-1996
Test Standard	JIS F7400-1996
Flange Standard	JIS B2220-5K
Application	Used for marine pipelines of Fresh Water, air or gas, Fuel Oil, Lub.oil, and Steam at 205°C or below

Material				
Part Nr.	Class S		Class B	
1- Body	Cast Iron	FC200	Cast Iron	FC200
2- Seat	Stainless Steel	SCS2	Bronze	CAC406
3- Disc	Stainless Steel	SCS2	Bronze	CAC406
4- Stem	Stainless Steel	SUS403	Brass	C3771BD

Hydraulic Inspection MPa[kgf/cm ²]		
Nominal dia.	Body	Seat
300 or less	1.03[10.5]	0.76[7.7]
350 & 400	0.88[9]	0.65[6.6]

Dimension Table										
Size	L	D	C	NO	h	t	H	D2	Weight[kg]	
									F7305	F7353
50	210	130	105	4	15	16	270	160	14.7	14.8
65	250	155	130	4	15	18	300	180	21.3	21.3
80	280	180	145	4	19	18	310	180	27.7	27.6
100	340	200	165	8	19	20	360	224	40.8	40.4
125	410	235	200	8	19	20	390	250	57.6	57.9
150	480	265	230	8	19	22	445	280	80.3	80.9
200	570	320	280	8	23	24	530	315	139	139
250	740	385	345	12	23	26	650	355	246	243
300	840	430	390	12	23	28	740	400	377	377
350	940	480	435	12	25	30	840	500	462	463
400	1050	540	495	16	25	30	940	630	647	643

JIS MARINE VALVE

Marine Cast Iron Angle Valve

Marine Cast Iron Angle SDNR Valve

F7306 -5K Angle Valve

F7354-5K Angle SDNR Valve

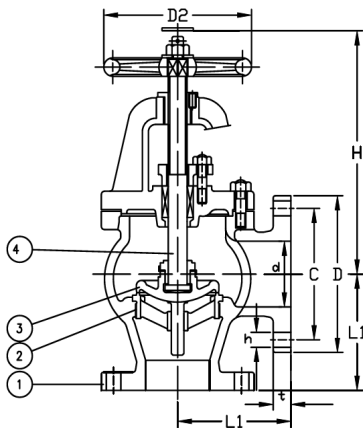

Series F7306

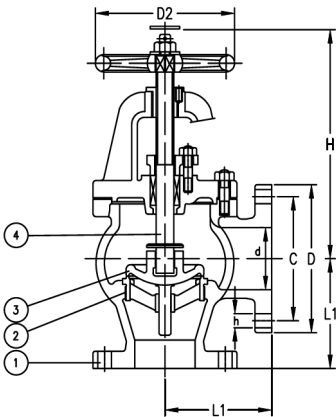

Series F7354(SDNR)

Technical Feature	
Design Standard	JIS F7425-1996
Test Standard	JIS F7400-1996
Flange Standard	JIS B2220-5K
Application	Used for marine pipelines of Fresh Water, air or gas, Fuel Oil, Lub.oil, and Steam at 205°C or below

Material				
Part Nr.	Class S		Class B	
1- Body	Cast Iron	FC200	Cast Iron	FC200
2- Seat	Stainless Steel	SCS2	Bronze	CAC406
3- Disc	Stainless Steel	SCS2	Bronze	CAC406
4- Stem	Stainless Steel	SUS403	Brass	C3771BD

Hydraulic Inspection MPa[kgf/cm ²]		
Nominal dia.	Body	Seat
300 or less	1.03[10.5]	0.76[7.7]
350 & 400	0.88[9]	0.65[6.6]

Dimension Table										
Size	L	D	C	NO	h	t	H	D2	Weight[kg]	
									F7306	F7354
50	100	130	105	4	15	16	240	160	12.9	12.9
65	115	155	130	4	15	18	255	180	18.2	18.2
80	130	180	145	4	19	18	265	180	23.4	23.3
100	150	200	165	8	19	20	310	224	33.7	33.5
125	170	235	200	8	19	20	330	250	46.2	46.5
150	190	265	230	8	19	22	380	280	63.4	64
200	220	320	280	8	23	24	450	315	105	104
250	275	385	345	12	23	26	540	355	176	175
300	310	430	390	12	23	28	610	400	243	243
350	360	480	435	12	25	30	690	500	327	336
400	395	540	495	16	25	30	770	630	459	455
450	440	605	555	16	25	30	835	630	618	618

JIS MARINE VALVE

Marine Cast Iron Globe Valve

Marine Cast Iron Globe SDNR Valve

F7307 -10K Globe Valve

F7375-10K Globe SDNR Valve

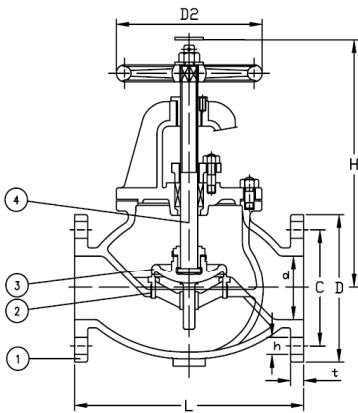

Series F7307

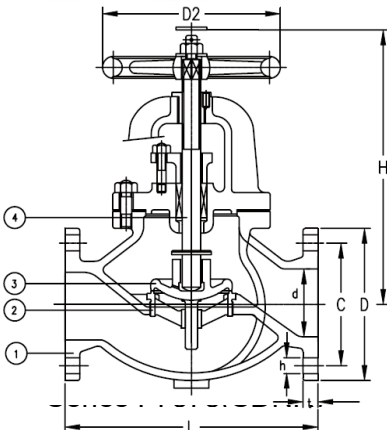

Technical Feature	
Design Standard	JIS F7426-1996
Test Standard	JIS F7400-1996
Flange Standard	JIS B2220-10K
Application	Used for marine pipelines of Fresh Water, air or gas, Fuel Oil, Lub.oil, and Steam at 205°C or below

Material				
Part Nr.	Class B		Class S	
1- Body	Cast Iron	FC200	Cast Iron	FC200
2- Seat	Stainless Steel	SCS2	Bronze	CAC406
3- Disc	Stainless Steel	SCS2	Bronze	CAC406
4- Stem	Stainless Steel	SUS403	Brass	C3771BD

Hydraulic Inspection MPa[kgf/cm ²]		
Nominal dia.	Body	Seat
200 or less	2.06[21]	1.51[15.4]
250 and more	1.47[15]	1.08[11]

Dimension Table										
Size	L	D	C	NO	h	t	H	D2	Weight[kg]	
									F7307	F7375
50	220	155	120	4	19	20	285	160	19.9	19.9
65	270	175	140	4	19	22	310	200	28.7	28.6
80	300	185	150	8	19	22	320	200	32.4	32.5
100	350	210	175	8	19	24	370	250	48.7	48.7
125	420	250	210	8	23	24	420	280	73.1	73
150	490	280	240	8	23	26	470	315	104	104
200	570	330	290	12	23	26	555	355	162	161
250	740	400	355	12	25	30	680	450	304	304
300	840	445	400	16	25	32	770	500	458	458
350	940	490	445	16	25	34	852	560	578	578

JIS MARINE VALVE

Marine Cast Iron Angle Valve

Marine Cast Iron Angle SDNR Valve

F7308 -10K Angle Valve

F7376-10K Angle SDNR Valve

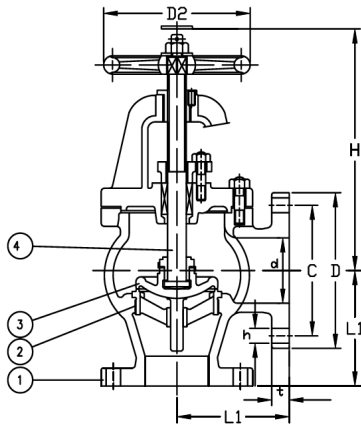

Series F7308

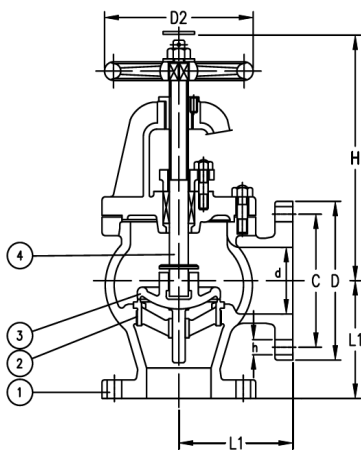

Series F7376(SDNR)

Technical Feature	
Design Standard	JIS F7425-1996
Test Standard	JIS F7400-1996
Flange Standard	JIS B2220-10K
Application	Used for marine pipelines of Fresh Water, air or gas, Fuel Oil, Lub.oil, and Steam at 205°C or below

Material				
Part Nr.	Class S		Class B	
1- Body	Cast Iron	FC200	Cast Iron	FC200
2- Seat	Stainless Steel	SCS2	Bronze	CAC406
3- Disc	Stainless Steel	SCS2	Bronze	CAC406
4- Stem	Stainless Steel	SUS403	Brass	C3771BD

Hydraulic Inspection MPa[kgf/cm ²]		
Nominal dia.	Body	Seat
200 or less	2.06[21]	1.51[15.4]
250 and more	1.47[15]	1.08[11]

Dimension Table										
Size	L	D	C	NO	h	t	H	D2	Weight[kg]	
									F7308	F7376
50	120	155	120	4	19	20	255	160	18.2	18.2
65	130	175	140	4	19	22	270/260	200	25.4	25.3
80	140	185	150	8	19	22	275/270	200	27.4	27.5
100	160	210	175	8	19	24	315/305	250	40.6	40.6
125	180	250	210	8	23	24	360/350	280	69.9	70
150	205	280	240	8	23	26	405/390	315	81	81
200	230	330	290	12	23	26	475/450	355	125	124
250	290	400	355	12	25	30	570	450	211	211
300	320	445	400	16	25	32	645	500	293	293
350	360	490	445	16	25	34	710	560	386	386
400	420	560	510	16	27	36	790	630	544	544

JIS MARINE VALVE

Marine Cast Iron Globe Valve

Marine Cast Iron Globe SDNR Valve

F7309 -16K Globe Valve

F7377-16K Globe SDNR Valve

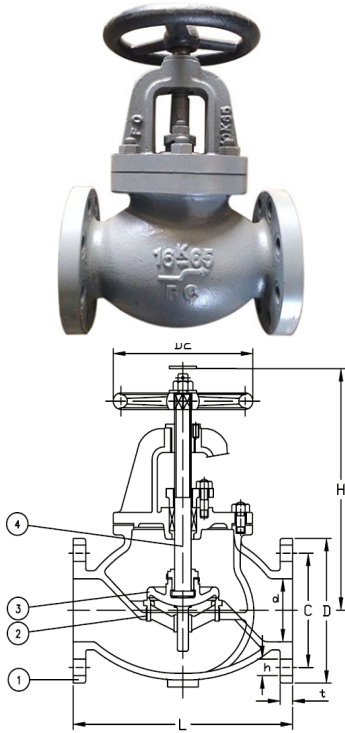

Series F7309

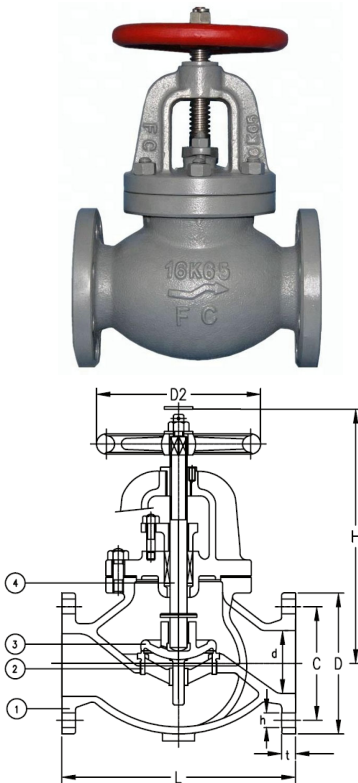

Series F7377(SDNR)

Technical Feature	
Design Standard	JIS F7426-1996
Test Standard	JIS F7400-1996
Flange Standard	JIS B2220-16K
Application	Used for marine pipelines of Fresh Water, air or gas, Fuel Oil, Lub.oil, and Steam at 205°C or below

Material				
Part Nr.	Class B		Class S	
1- Body	Cast Iron	FC200	Cast Iron	FC200
2- Seat	Stainless Steel	SCS2	Bronze	CAC406
3- Disc	Stainless Steel	SCS2	Bronze	CAC406
4- Stem	Stainless Steel	SUS403	Brass	C3771BD

Hydraulic Inspection MPa[kgf/cm ²]		
Nominal dia.	Body	Seat
200 or less	3.2[33]	2.38[24.2]

Dimension Table										
Size	L	D	C	NO	h	t	H	D2	Weight[kg]	
									F7309	F7377
50	220	155	120	8	19	20	285	160	19.6	19.6
65	270	175	140	8	19	22	310	200	28.3	28.2
80	300	200	160	8	23	24	340	224	40.4	40.5
100	350	225	185	8	23	26	385	250	56.9	56.9
125	430	270	225	8	25	26	455	315	89.5	89.5
150	500	305	260	12	25	28	510	355	123	123
200	570	350	305	12	25	30	630	450	188	188

JIS MARINE VALVE

Marine Cast Iron Angle Valve

Marine Cast Iron Angle SDNR Valve

F7310 -16K Angle Valve

F7378-16K Angle SDNR Valve

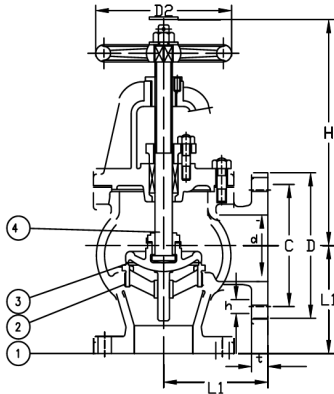

Series F7310

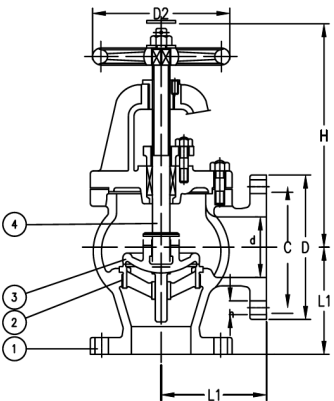

Series F7378(SDNR)

Technical Feature	
Design Standard	JIS F7425-1996
Test Standard	JIS F7400-1996
Flange Standard	JIS B2220-16K
Application	Used for marine pipelines of Fresh Water, air or gas, Fuel Oil, Lub.oil, and Steam at 205°C or below

Material				
Part Nr.	Class S		Class B	
1- Body	Cast Iron	FC200	Cast Iron	FC200
2- Seat	Stainless Steel	SCS2	Bronze	CAC406
3- Disc	Stainless Steel	SCS2	Bronze	CAC406
4- Stem	Stainless Steel	SUS403	Brass	C3771BD

Hydraulic Inspection MPa[kgf/cm ²]		
Nominal dia.	Body	Seat
200 or less	3.2[33]	2.38[24.2]

Dimension Table										
Size	L	D	C	NO	h	t	H	D2	Weight[kg]	
									F7310	F7378
50	120	155	120	8	19	20	255	160	18	18
65	130	175	140	8	19	22	270	200	25	25
80	150	200	160	8	23	24	295	224	35.7	35.7
100	170	225	185	8	23	26	330	250	49.2	49.2
125	200	270	225	8	25	26	390	315	76.1	76.1
150	225	305	260	12	25	28	435	355	103	103
200	250	350	305	12	25	30	540	450	155	155

JIS MARINE VALVE

Marine Malleable Iron & Ductile Iron Globe Valve
Marine Malleable Iron & Ductile Iron Angle Valve

F7321-5K Globe Valve
F7322-5K Angle Valve

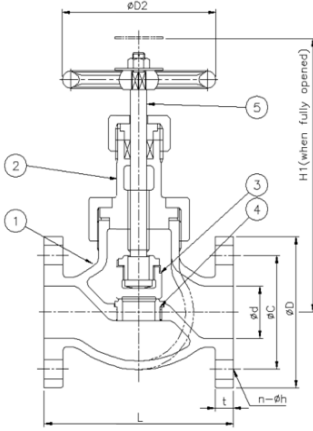

Series F7321

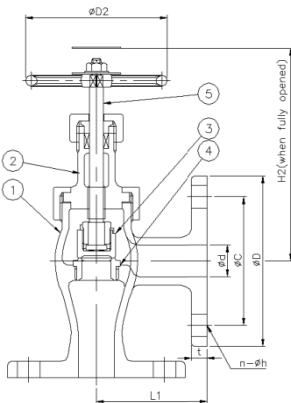

Series F7322

Technical Feature	
Design Standard	JIS F7425-1996
Test Standard	JIS F7400-1996
Flange Standard	JIS B2220-5K/16K
Application	Used for marine pipelines of Fresh Water, air or gas, Fuel Oil, Lub.oil, and Steam at 205°C or below

Material				
Part Nr.	Class B		Class S	
1- Body	Ductile Iron	FCD400	Cast Iron	FC200
2- Bonnet	Ductile Iron	FCD400	Cast Iron	FC200
3- Seat	Bronze	CAC406	Stainless Steel	SCS2
4- Disc	Bronze	CAC406	Stainless Steel	SCS2
5- Stem	Brass	C3771BD	Stainless Steel	SUS403

Hydraulic Inspection MPa[kgf/cm ²]		
Nominal dia.	Body	Seat
15-40	1.03[10.5]	0.76[7.7]

Dimension Table												
Size	L	L1	D	C	NO	h	t	H1	H2	D2	Weight[kg]	
											F7321	F7322
5K15	100	55	80	60	4	12	9	145	135	80	1.98	1.89
5K20	110	60	85	65	4	12	10	160	150	100	2.8	2.65
5K25	120	65	95	75	4	12	10	185	175	125	4.18	3.85
5K32	140	80	115	90	4	15	12	195	180	125	5.53	5.29
5K40	160	85	120	95	4	15	12	215	200	140	7.08	6.86

JIS MARINE VALVE

Marine Malleable Iron & Ductile Iron Globe Valve
Marine Malleable Iron & Ductile Iron Angle Valve

F7323-16K Globe Valve
F7324-16K Angle Valve

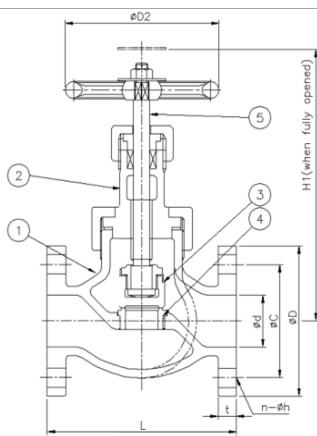

Series F7323

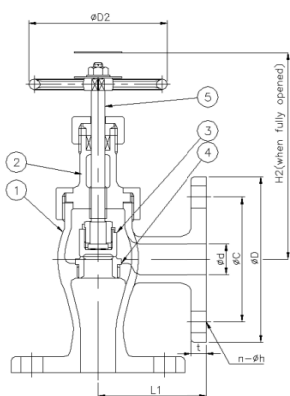

Series F7324

Technical Feature	
Design Standard	JIS F7425-1996
Test Standard	JIS F7400-1996
Flange Standard	JIS B2220-5K
Application	Used for marine pipelines of Fresh Water, air or gas, Fuel Oil, Lub.oil, and Steam at 205°C or below

Material				
Part Nr.	Class B		Class S	
1- Body	Ductile Iron	FCD400	Cast Iron	FC200
2- Bonnet	Ductile Iron	FCD400	Cast Iron	FC200
3- Seat	Bronze	CAC406	Stainless Steel	SCS2
4- Disc	Bronze	CAC406	Stainless Steel	SCS2
5- Stem	Brass	C3771BD	Stainless Steel	SUS403

Hydraulic Inspection MPa[kgf/cm ²]		
Nominal dia.	Body	Seat
15-40	3.3[33.0]	2.42[24.2]

Dimension Table												
Size	L	L1	D	C	NO	h	t	H1	H2	D2	Weight[kg]	
											F7323	F7324
16K15	110	70	80	60	4	12	9	145	135	80	2.91	2.85
16K20	120	75	85	65	4	12	10	160	150	100	3.85	3.75
16K25	130	85	95	75	4	12	10	185	175	125	5.57	5.36
16K32	160	95	115	90	4	15	12	195	180	125	7.4	7.05
16K40	180	100	120	95	4	15	12	215	200	140	9.29	8.8

JIS MARINE VALVE

Marine Cast Iron Globe Hose Valve
with Nakajima Coupling

F7333A-5K/10K Globe Hose Valve

Technical Feature	
Design Standard	JIS F7426-1996
Test Standard	JIS F7400-1996
Flange Standard	JIS B2220-5K/10K
Application	Used for marine pipelines of Fresh Water, air or gas, Fuel Oil, Lub.oil, and Steam at 205°C or below

Material				
Part Nr.	Class B		Class S	
1- Body	Cast Iron	FC200	Cast Iron	FC200
2- Seat	Stainless Steel	SCS2	Bronze	CAC406
3- Disc	Stainless Steel	SCS2	Bronze	CAC406
4- Stem	Stainless Steel	SUS403	Brass	C3771BD

Hydraulic Inspection MPa[kgf/cm ²]		
Nominal dia.	Body	Seat
5K	1.03[10.5]	0.76[7.7]
10K	2.1[21.0]	1.54[15.4]

Dimension Table										
Size	L	D	C	NO	h	t	H	D2	d3	Weight [kg]
5K50	215	130	105	4	15	16	270	160	M64*2	14.7
5K65	275	155	130	4	15	18	310	200	M80*2	28.2
10K50	225	155	120	4	19	20	285	160	M64*2	18.9
10K65	275	175	140	4	19	22	310	200	M80*2	28.2

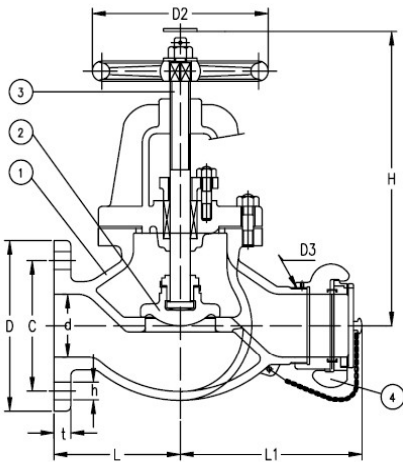

Series F7333A

JIS MARINE VALVE

Marine Cast Iron Angle Hose Valves
with Nakajima Coupling

F7333B-5K/10K Angle Hose Valve

Technical Feature	
Design Standard	JIS F7425-1996
Test Standard	JIS F7400-1996
Flange Standard	JIS B2220-5K/10K
Application	Used for marine pipelines of Fresh Water, air or gas, Fuel Oil, Lub.oil, and Steam at 205°C or below

Material				
Part Nr.	Class S		Class B	
1- Body	Cast Iron	FC200	Cast Iron	FC200
2- Seat	Stainless Steel	SCS2	Bronze	CAC406
3- Disc	Stainless Steel	SCS2	Bronze	CAC406
4- Stem	Stainless Steel	SUS403	Brass	C3771BD

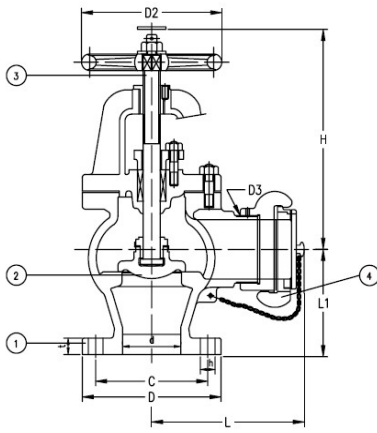

Hydraulic Inspection MPa[kgf/cm ²]		
Nominal dia.	Body	Seat
5K	1.03[10.5]	0.76[7.7]
10K	2.1[21.0]	1.54[15.4]



Series F7333B

Dimension Table										
Size	L	D	C	NO	h	t	H	D2	d3	Weight [kg]
5K50	100	130	105	4	15	16	240	160	M64*2	12.8
5K65	130	155	130	4	15	18	270	200	M80*2	24.3
10K50	120	155	120	4	19	20	255	160	M64*2	17
10K65	130	175	140	4	19	22	270	200	M80*2	24.3

JIS MARINE VALVE

Marine Cast Iron Lift Check Valve

F7358 -5K Lift Check Globe Valve

F7359-5K Lift Check Angle Valve

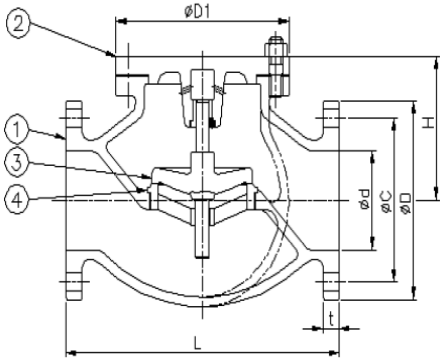

Series F7358 5K

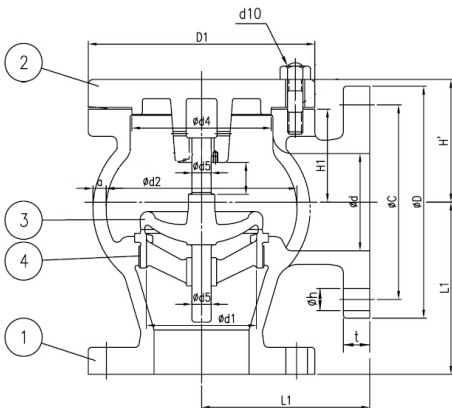

Series F7359 5K

Technical Feature	
Design Standard	JIS F7425-1996
Test Standard	JIS F7400-1996
Flange Standard	JIS B2220-5K
Application	Used for marine pipelines of Fresh Water, air or gas, Fuel Oil, Lub.oil, and Steam at 205°C or below

Material				
Part Nr.	Class S		Class B	
1- Body	Cast Iron	FC200	Cast Iron	FC200
2- Seat	Stainless Steel	SCS2	Bronze	CAC406
3- Disc	Stainless Steel	SCS2	Bronze	CAC406
4- Stem	Stainless Steel	SUS403	Brass	C3771BD

Hydraulic Inspection MPa[kgf/cm2]		
PN	Body	Seat
5K	1.05[10.5]	0.77[7.7]

Dimension Table									
Size	L	D	C	NO	h	t	H	D2	Weight[kg] F7358
50	210	130	105	4	15	16	107	140	11.3
65	250	155	130	4	15	18	124	160	16.8
80	280	180	145	4	19	18	129	190	23.2
100	340	200	165	8	19	20	146	215	32.5
125	410	235	200	8	19	20	166	245	48.1
150	480	265	230	8	19	22	188	270	67.9
200	570	320	280	8	23	24	235	335	115.0

Dimension Table									
Size	L1	D	C	NO	h	t	H'	D2	Weight[kg] F7359
50	100	155	120	4	19	20	77	140	9.5
65	115	175	140	4	19	22	81	160	13.8
80	130	185	150	8	19	22	84	190	18.9
100	150	210	175	8	19	24	96	215	25.6
125	170	250	210	8	23	24	108	245	36.7
150	190	280	240	8	23	26	125	270	50.9
200	220	330	290	12	23	26	157	335	95.0

JIS MARINE VALVE

Marine Cast Iron Swing Check Valve

F7372 -5K Swing Check Valve F7373-10K Swing Check Valve

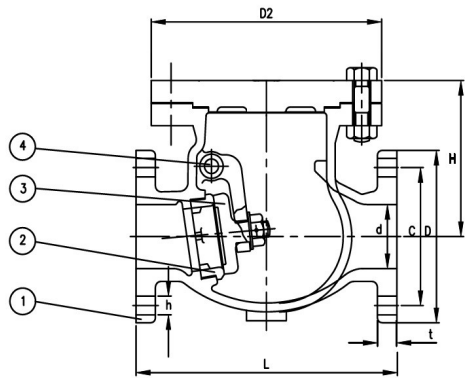

Technical Feature	
Design Standard	JIS F7425-1996
Test Standard	JIS F7400-1996
Flange Standard	JIS B2220-5K/10K
Application	Used for marine pipelines of Fresh Water, air or gas, Fuel Oil, Lub.oil, and Steam at 205°C or below

Material				
Part Nr.	Class S		Class B	
1- Body	Cast Iron	FC200	Cast Iron	FC200
2- Arm	-	-	Bronze	CAC406
3- Disc	-	-	Bronze	CAC406
4- Seat	-	-	Bronze	CAC406

Hydraulic Inspection MPa[kgf/cm ²]		
PN	Body	Seat
5K	1.05[10.5]	0.77[7.7]
10K	2.1[21.0]	1.54[15.4]



Series F7372 5K



Series F7373 10K

Dimension Table									
Size	L	D	C	NO	h	t	H	D2	Weight[kg]
									F7372
50	190	130	105	4	15	16	97	135	9.06
65	220	155	130	4	15	18	119	155	13.9
80	250	180	145	4	19	18	129	185	19.1
100	280	200	165	8	19	20	146	205	27.1
125	330	235	200	8	19	20	171	235	39
150	380	265	230	8	19	22	198	265	53.7
200	460	320	280	8	23	24	235	300	94.4
250	550	385	345	12	23	26	290	390	150
300	700	430	390	12	23	28	290	470	-

Dimension Table									
Size	L	D	C	NO	h	t	H	D2	Weight[kg]
									F7373
50	210	155	120	4	19	20	109	150	13.6
65	240	175	140	4	19	22	126	170	19.6
80	270	185	150	8	19	22	136	185	22.6
100	300	210	175	8	19	24	153	205	30.9
125	250	250	210	8	23	24	180	250	49.2
150	400	280	240	8	23	26	205	275	64.9
200	480	330	290	12	23	26	242	330	103.0
250	550	400	355	12	25	30	290	390	0.0
300	700	445	400	16	25	32	290	470	-

JIS MARINE VALVE

Marine Cast Iron Gate Valve

F7363 -5K Gate Valve

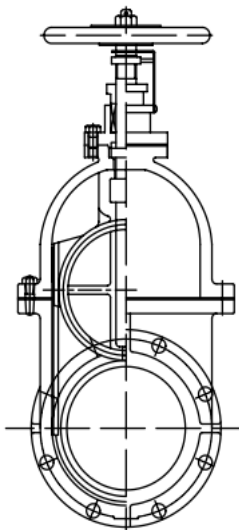
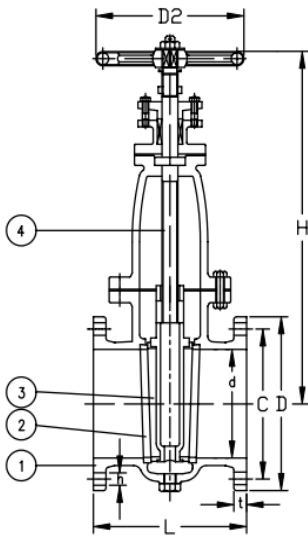

Series F7363

Technical Feature	
Design Standard	JIS F7426-1996
Test Standard	JIS F7400-1996
Flange Standard	JIS B2220-5K
Application	Used for marine pipelines of Fresh Water, air or gas, Fuel Oil, Lub.oil, and Steam at 205°C or below

Material				
Part Nr.	Class S		Class B	
1- Body	Cast Iron	FC200	Cast Iron	FC200
2- Seat	Stainless Steel	SCS2	Bronze	CAC406
3- Disc	Stainless Steel	SCS2	Bronze	CAC406
4- Stem	Stainless Steel	SUS403	Brass	C3771BD

Hydraulic Inspection MPa[kgf/cm ²]		
Nominal dia.	Body	Seat
25-300	1.03[10.5]	0.76[7.7]
350-450	0.88[9]	0.65[6.6]

Dimension Table-F7363 JIS 5K										
Size	L	D	C	NO	h	t	H	D2	Weight[kg]	
									F7363	F7367
25	110	95	75	4	12	10	220	80	-	4.1
32	130	115	90	4	15	12	250	80	-	5.79
40	140	120	95	4	15	12	290	100	-	7.78
50	180	130	105	4	15	16	285	125	13.5	-
65	190	155	130	4	15	18	330	140	19	-
80	200	180	145	4	19	18	380	160	24.2	-
100	230	200	165	8	19	20	430	180	35.3	-
125	250	235	200	8	19	20	495	200	48.1	-
150	270	265	230	8	19	22	560	224	65.3	-
200	290	320	280	8	23	24	680	280	103	-
250	330	385	345	12	23	26	800	355	164	-
300	370	430	390	12	23	28	920	400	236	-
350	410	480	435	12	25	30	1000	450	307	-
400	470	540	495	16	25	30	1100	500	405	-
450	500	605	555	16	25	30	1420	560	556	-

JIS MARINE VALVE

Marine Cast Iron Gate Valve

F7364 -10K Gate Valve



Technical Feature	
Design Standard	JIS F7425-1996
Test Standard	JIS F7400-1996
Flange Standard	JIS B2220-10K
Application	Used for marine pipelines of Fresh Water, air or gas, Fuel Oil, Lub.oil, and Steam at 205°C or below

Material				
Part Nr.	Class S		Class B	
1- Body	Cast Iron	FC200	Cast Iron	FC200
2- Seat	Stainless Steel	SCS2	Bronze	CAC406
3- Disc	Stainless Steel	SCS2	Bronze	CAC406
4- Stem	Stainless Steel	SUS403	Brass	C3771BD

Hydraulic Inspection MPa[kgf/cm ²]		
Nominal dia.	Body	Seat
15-400	2.1[21]	1.54[15.4]
450 or more	1.8[18.0]	1.32[13.2]

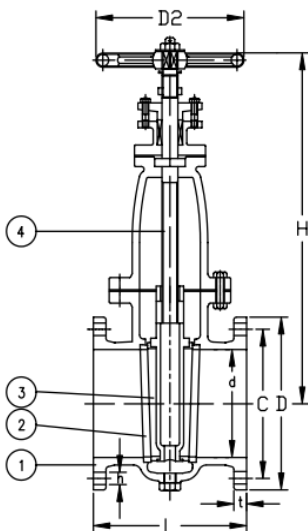

Dimension Table-F7364 JIS 10K										
Size	L	D	C	NO	h	t	H	D2	Weight[kg]	
									F7364	F7368
25	120	125	90	4	19	14	220	125	-	5.82
32	140	135	100	4	19	16	250	125	-	7.52
40	150	140	105	4	19	16	290	140	-	9.71
50	200	155	120	4	19	20	300	140	19.4	-
65	220	175	140	4	19	22	350	160	27.6	-
80	230	185	150	8	19	22	400	180	33	-
100	250	210	175	8	19	24	450	224	45.8	-
125	270	250	210	8	23	24	520	250	65.9	-
150	290	280	240	8	23	26	580	315	86	-
200	320	330	290	12	23	26	700	400	136	-
250	380	400	355	12	25	30	840	450	230	-
300	440	445	400	16	25	32	960	500	331	-
350	500	490	445	16	25	34	1050	500	433	-
400	590	540	495	16	25	36	1150	560	597	-
450	640	605	555	16	25	38	1208	560	702	-

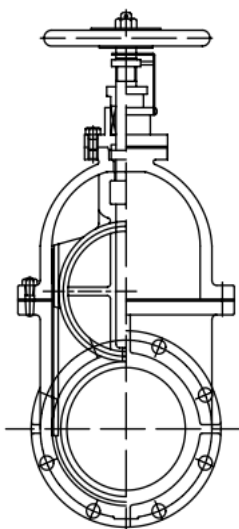

Series F7364

JIS MARINE VALVE

Marine Cast Iron Gate Valve

F7369 -16K Gate Valve

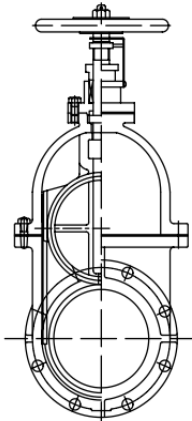
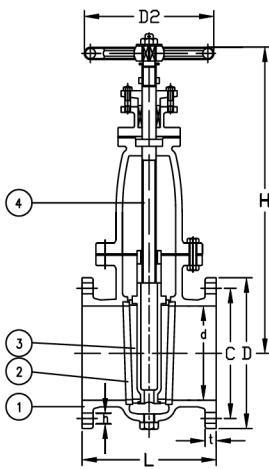

Series F7369

Technical Feature	
Design Standard	JIS F7425-1996
Test Standard	JIS F7400-1996
Flange Standard	JIS B2220-16K
Application	Used for marine pipelines of Fresh Water, air or gas, Fuel Oil, Lub.oil, and Steam at 205°C or below

Material				
Part Nr.	Class S		Class B	
1- Body	Cast Iron	FC200	Cast Iron	FC200
2- Seat	Stainless Steel	SCS2	Bronze	CAC406
3- Disc	Stainless Steel	SCS2	Bronze	CAC406
4- Stem	Stainless Steel	SUS403	Brass	C3771BD

Hydraulic Inspection MPa[kgf/cm ²]		
Nominal dia.	Body	Seat
15-400	2.4[24]	1.76[17.6]

Dimension Table-F7369 JIS 16K										
Size	L	D	C	NO	h	t	H	D2	Weight[kg]	
									F7369	
50	210	155	120	4	19	20	300	140	19.4	-
65	240	175	140	4	19	22	350	160	27.6	-
80	234	185	150	8	19	22	400	180	33	-
100	290	210	175	8	19	24	450	224	45.8	-
125	310	250	210	8	23	24	520	250	65.9	-
150	330	280	240	8	23	26	580	315	86	-
200	370	330	290	12	23	26	700	400	136	-
250	430	400	355	12	25	30	840	450	230	-

JIS MARINE VALVE

Marine Cast Steel Globe Valve

Marine Cast Steel Globe SDNR Valve

F7311 -5K Globe Valve

F7311C-5K Globe SDNR Valve

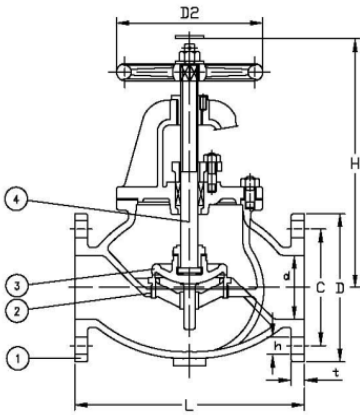

Series F7311

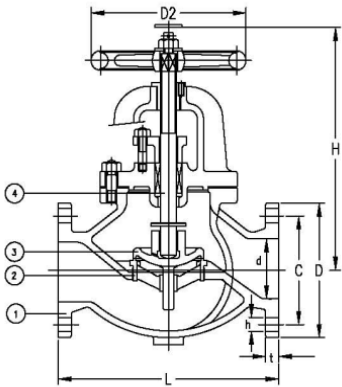

Series F7311C(SDNR)

Technical Feature	
Design Standard	JIS F7427-1996
Test Standard	JIS F7400-1996
Flange Standard	JIS B2220-5K
Application	Used for marine pipelines of Fresh Water, air or gas, Fuel Oil, Lub.oil, and Steam at 205°C or below

Material				
Part Nr.	Class S		Class B	
1- Body	Cast Steel	SC480	Cast Steel	SC480
2- Seat	Stainless Steel	SCS2	Bronze	CAC406
3- Disc	Stainless Steel	SCS2	Bronze	CAC406
4- Stem	Stainless Steel	SUS403	Brass	C3771BD

Hydraulic Inspection MPa[kgf/cm ²]		
Nominal dia.	Body	Seat
300 or less	1.03[10.5]	0.76[7.7]
350 & 400	0.88[9]	0.65[6.6]

Dimension Table										
Size	L	D	C	NO	h	t	H	D2	Weight[kg]	
									F7311	F7311C
50	210	130	105	4	15	16	270	160	14.7	14.8
65	250	155	130	4	15	18	300	180	21.3	21.3
80	280	180	145	4	19	18	310	180	27.7	27.6
100	340	200	165	8	19	20	360	224	40.8	40.4
125	410	235	200	8	19	20	390	250	57.6	57.9
150	480	265	230	8	19	22	445	280	80.3	80.9
200	570	320	280	8	23	24	530	315	139	139
250	740	385	345	12	23	26	650	355	246	243
300	840	430	390	12	23	28	740	400	377	377
350	940	480	435	12	25	30	840	500	462	463
400	1050	540	495	16	25	30	940	630	647	643

JIS MARINE VALVE

Marine Cast Steel Angle Valve

Marine Cast Steel Angle SDNR Valve

F7312 -5K Angle Valve

F7312C-5K Angle SDNR Valve

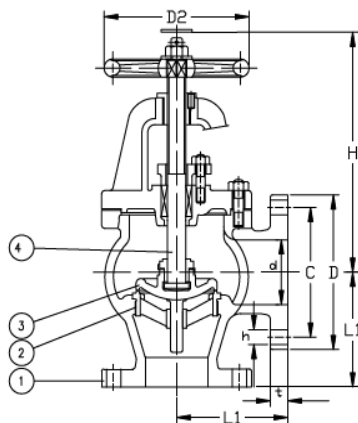

Series F7312

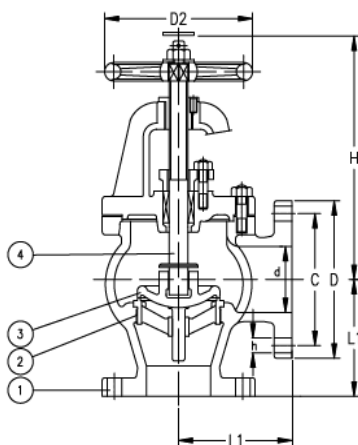

Series F7312C(SDNR)

Technical Feature	
Design Standard	JIS F7427-1996
Test Standard	JIS F7400-1996
Flange Standard	JIS B2220-5K
Application	Used for marine pipelines of Fresh Water, air or gas, Fuel Oil, Lub.oil, and Steam at 205°C or below

Material				
Part Nr.	Class S		Class B	
1- Body	Cast Steel	SC480	Cast Steel	SC480
2- Seat	Stainless Steel	SCS2	Bronze	CAC406
3- Disc	Stainless Steel	SCS2	Bronze	CAC406
4- Stem	Stainless Steel	SUS403	Brass	C3771BD

Hydraulic Inspection MPa[kgf/cm ²]		
Nominal dia.	Body	Seat
300 or less	1.03[10.5]	0.76[7.7]
350 & 400	0.88[9]	0.65[6.6]

Dimension Table										
Size	L1	D	C	NO	h	t	H	D2	Weight[kg]	
									F7312	F7312C
50	100	130	105	4	15	16	240	160	12.9	12.9
65	115	155	130	4	15	18	255	180	18.2	18.2
80	130	180	145	4	19	18	265	180	23.4	23.3
100	150	200	165	8	19	20	310	224	33.7	33.5
125	170	235	200	8	19	20	330	250	46.2	46.5
150	190	265	230	8	19	22	380	280	63.4	64
200	220	320	280	8	23	24	450	315	105	104
250	275	385	345	12	23	26	540	355	178	175
300	310	430	390	12	23	28	610	400	275	243
350	360	480	435	12	25	30	840	500	415	393
400	395	540	495	16	25	30	940	610	578	565

JIS MARINE VALVE

Marine Cast Steel Globe Valve

Marine Cast Steel Globe SDNR Valve

F7319 -10K Globe Valve

F7471-10K Globe SDNR Valve

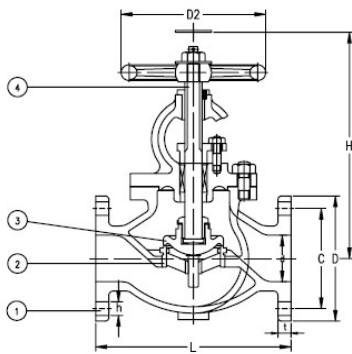

Series F7319

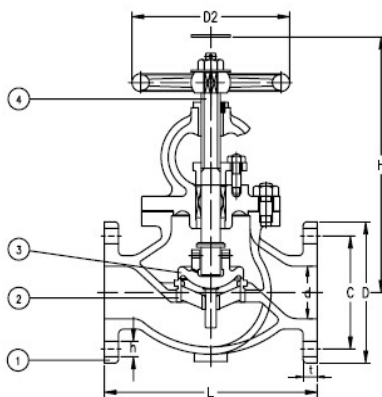

Series F7471(SDNR)

Technical Feature	
Design Standard	JIS F7426-1996
Test Standard	JIS F7400-1996
Flange Standard	JIS B2220-10K
Application	Used for marine pipelines of Fresh Water, air or gas, Fuel Oil, Lub.oil, and Steam at 205℃ or below

Material				
Part Nr.	Class S		Class B	
1- Body	Cast Steel	SC480	Cast Steel	SC480
2- Seat	Stainless Steel	SCS2	Bronze	CAC406
3- Disc	Stainless Steel	SCS2	Bronze	CAC406
4- Stem	Stainless Steel	SUS403	Brass	C3771BD

Hydraulic Inspection MPa[kgf/cm ²]		
Nominal dia.	Body	Seat
200 or less	2.06[21]	1.51[15.4]
250 and more	1.47[15]	1.08[11]

Dimension Table										
Size	L	D	C	NO	h	t	H	D2	Weight[kg]	
									F7319	F7471
50	220	155	120	4	19	16	270	160	17.9	17.9
65	270	175	140	4	19	18	300	200	26	26.1
80	300	185	150	8	19	18	310	200	29.8	29.8
100	350	210	175	8	19	18	355	250	44.7	44.8
125	420	250	210	8	23	20	415	280	70.3	70
150	490	280	240	8	23	22	470	315	96.4	96
200	570	330	290	12	23	22	565	355	159	158
250	740	400	355	12	25	24	645	400	257	257
300	840	445	400	16	25	24	735	500	370	370

JIS MARINE VALVE

Marine Cast Steel Angle Valve

Marine Cast Steel Angle SDNR Valve

F7320 -10K Angle Valve

F7472-10K Angle SDNR Valve

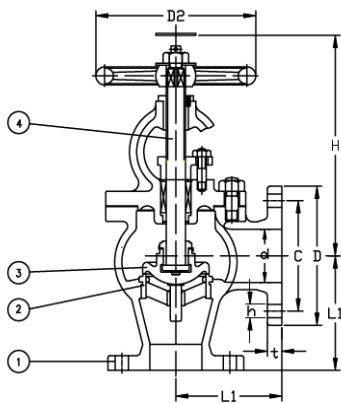

Series F7320

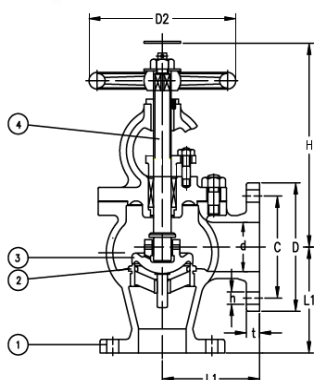

Series F7472(SDNR)

Technical Feature	
Design Standard	JIS F7426-1996
Test Standard	JIS F7400-1996
Flange Standard	JIS B2220-10K
Application	Used for marine pipelines of Fresh Water, air or gas, Fuel Oil, Lub.oil, and Steam at 205°C or below

Material				
Part Nr.	Class S		Class B	
1- Body	Cast Steel	SC480	Cast Steel	SC480
2- Seat	Stainless Steel	SCS2	Bronze	CAC406
3- Disc	Stainless Steel	SCS2	Bronze	CAC406
4- Stem	Stainless Steel	SUS403	Brass	C3771BD

Hydraulic Inspection MPa[kgf/cm ²]		
Nominal dia.	Body	Seat
200 or less	2.06[21]	1.51[15.4]
250 and more	1.47[15]	1.08[11]

Dimension Table										
Size	L	D	C	NO	h	t	H	D2	Weight[kg]	
									F7320	F7472
50	120	155	120	4	19	16	240	160	16.3	16.3
65	130	175	140	4	19	18	260	200	23	23.1
80	140	185	150	8	19	18	265	200	25.3	25.3
100	160	210	175	8	19	18	300	250	37	37
125	180	250	210	8	23	20	350	280	57.1	56.6
150	205	280	240	8	23	22	400	315	77.2	77.1
200	230	330	290	12	23	22	480	355	116	116
250	290	400	355	12	25	24	535	400	188	188
300	320	445	400	16	25	24	610	450	258	258
350	360/320	490	445	16	25	26	718	560	376	376
400	400/350	560	510	16	27	28	790	630	490	490
450	450/380	620	565	20	27	30	1200	630	632	632

JIS MARINE VALVE

Marine Cast Steel Globe Valve

Marine Cast Steel Globe SDNR Valve

F7313 -20K Angle Valve

F7473-20K Angle SDNR Valve

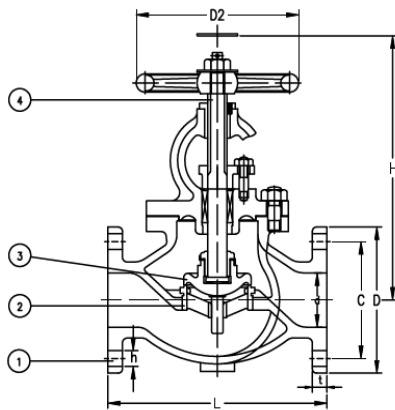

Series F7313

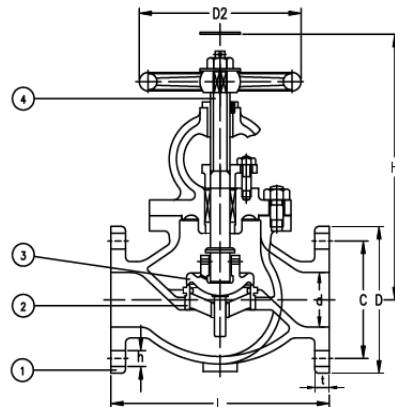

Series F7473(SDNR)

Technical Feature

Design Standard	JIS F7426-1996
Test Standard	JIS F7400-1996
Flange Standard	JIS B2220-20K
Application	Used for marine pipelines of Fresh Water, air or gas, Fuel Oil, Lub.oil, and Steam at 205°C or below

Material

Part Nr.	Class S		Class B	
	Material	Grade	Material	Grade
1- Body	Cast Steel	SC480	Cast Steel	SC480
2- Seat	Stainless Steel	SCS2	Bronze	CAC406
3- Disc	Stainless Steel	SCS2	Bronze	CAC406
4- Stem	Stainless Steel	SUS403	Brass	C3771BD

Hydraulic Inspection MPa[kgf/cm²]

Nominal dia.	Body	Seat
250 or less	5.00[51.0]	3.67[37.4]

Dimension Table

Size	L	D	C	NO	h	t	H	D2	Weight[kg]	
									F7313	F7473
32	190	135	100	4	19	18	270	160	14.4	14.4
40	200	140	105	4	19	18	290	160	16	16.0
50	230	155	120	8	19	18	305	200	21.6	21.6
65	270	175	140	8	19	20	345	224	30.4	30.4
80	300	200	160	8	23	22	385	250	43.5	44
100	350	225	185	8	23	24	440	280	62.3	62
125	430	270	225	8	25	26	500	315	95.7	96
150	500	305	260	12	25	28	550	355	133.3	133
200	560	350	305	12	25	30	630	450	296.1	212
250	660	430	380	12	27	34	725	560	339.1	339

JIS MARINE VALVE

Marine Cast Steel Angle Valve

Marine Cast Steel Angle SDNR Valve

F7314-20K Angle Valve

F7474-20K Angle SDNR Valve

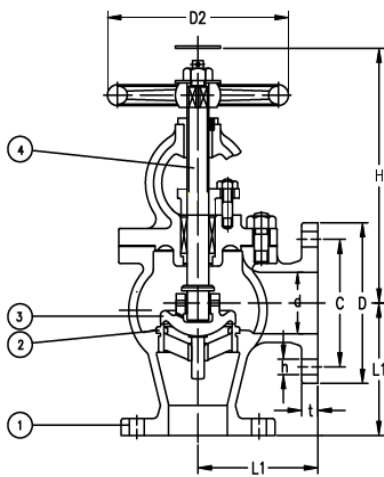
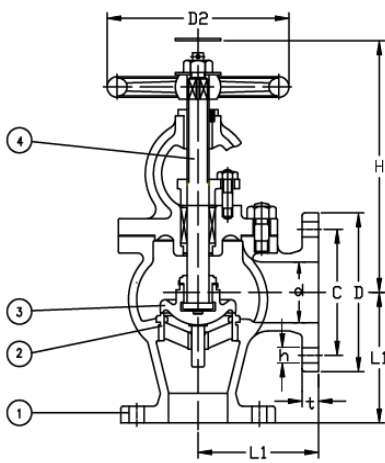

Series F7474(SDNR)

Technical Feature	
Design Standard	JIS F7426-1996
Test Standard	JIS F7400-1996
Flange Standard	JIS B2220-20K
Application	Used for marine pipelines of Fresh Water, air or gas, Fuel Oil, Lub.oil, and Steam at 205°C or below

Material				
Part Nr.	Class S		Class B	
1- Body	Cast Steel	SC480	Cast Steel	SC480
2- Seat	Stainless Steel	SCS2	Bronze	CAC406
3- Disc	Stainless Steel	SCS2	Bronze	CAC406
4- Stem	Stainless Steel	SUS403	Brass	C3771BD

Hydraulic Inspection MPa[kgf/cm ²]		
Nominal dia.	Body	Seat
250 or less	5.00[51.0]	3.67[37.4]

Dimension Table										
Size	L	D	C	NO	h	t	H	D2	Weight[kg]	
									F7314	F7474
50	100	135	100	4	19	18	240	160	13	13
65	110	140	105	4	19	18	255	160	15.2	15.1
80	125	155	120	8	19	18	270	200	20	19.9
100	135	175	140	8	19	20	295	224	26.9	26.7
125	150	200	160	8	23	22	325	250	38.9	38.8
150	170	225	185	8	23	24	365	280	54.4	54.2
200	200	270	225	8	25	26	415	315	80.7	83
250	225	305	260	12	25	28	460	355	112.3	115

JIS MARINE VALVE

Marine Cast Steel Gate Valve

F7363C -5K Gate Valve

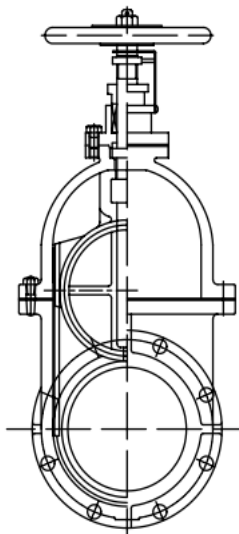
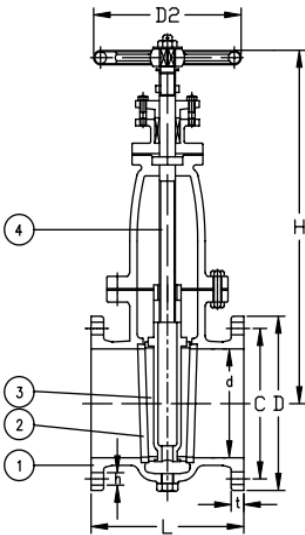

Series F7363C

Technical Feature	
Design Standard	JIS F7426-1996
Test Standard	JIS F7400-1996
Flange Standard	JIS B2220-5K
Application	Used for marine pipelines of Fresh Water, air or gas, Fuel Oil, Lub.oil, and Steam at 205°C or below

Material				
Part Nr.	Class S		Class B	
1- Body	Cast Steel	SC480	Cast Steel	SC480
2- Seat	Stainless Steel	SCS2	Bronze	CAC406
3- Disc	Stainless Steel	SCS2	Bronze	CAC406
4- Stem	Stainless Steel	SUS403	Brass	C3771BD

Hydraulic Inspection MPa[kgf/cm ²]		
Nominal dia.	Body	Seat
50-300	1.03[10.5]	0.76[7.7]
350	0.88[9]	0.65[6.6]

Dimension Table-F7363C JIS 5K									
Size	L	D	C	NO	h	t	H	D2	Weight
									[kg]
40	140	120	95	4	15	12	290	100	13.5
50	180	130	105	4	15	16	285	125	13.5
65	190	155	130	4	15	18	330	140	19
80	200	180	145	4	19	18	380	160	24.2
100	230	200	165	8	19	20	430	180	35.3
125	250	235	200	8	19	20	495	200	48.1
150	270	265	230	8	19	22	560	224	65.3
200	290	320	280	8	23	24	680	280	103
250	330	385	345	12	23	26	800	355	164
300	370	430	390	12	23	28	920	400	236
350	410	480	435	12	25	30	1000	450	307

JIS MARINE VALVE

Marine Cast Steel Gate Valve

F7366 -10K Gate Valve

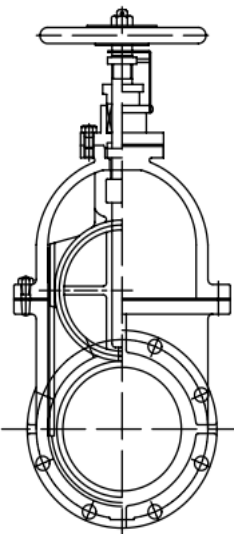
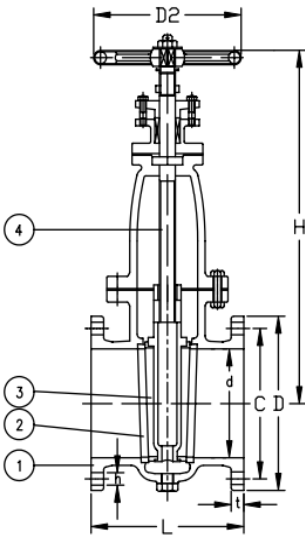

Series F7366

Technical Feature	
Design Standard	JIS F7426-1996
Test Standard	JIS F7400-1996
Flange Standard	JIS B2220-10K
Application	Used for marine pipelines of Fresh Water, air or gas, Fuel Oil, Lub.oil, and Steam at 205°C or below

Material				
Part Nr.	Class S		Class B	
1- Body	Cast Steel	SC480	Cast Steel	SC480
2- Seat	Stainless Steel	SCS2	Bronze	CAC406
3- Disc	Stainless Steel	SCS2	Bronze	CAC406
4- Stem	Stainless Steel	SUS403	Brass	C3771BD

Hydraulic Inspection MPa[kgf/cm ²]		
Nominal dia.	Body	Seat
50-300	2.06[21]	1.51[15.4]
350	1.76[18]	1.3[13.2]

Dimension Table-F7366 JIS 5K									
Size	L	D	C	NO	h	t	H	D2	Weight
									[kg]
40	140	120	95	4	15	12	290	100	17.1
50	200	155	120	4	19	16	300	140	17.1
65	220	175	140	4	19	18	350	160	26.5
80	230	185	150	8	19	18	400	180	31.5
100	250	210	175	8	19	18	450	200	44.9
125	270	250	210	8	23	20	520	224	63.2
150	290	280	240	8	23	22	580	250	82.3
200	310	330	290	12	23	22	700	315	130
250	340	400	355	12	25	24	840	400	203
300	380	445	400	16	25	24	960	450	291
350	420	490	445	16	25	26	1050	500	368

JIS MARINE VALVE

Marine Vertical Storm Valve
Marine Angle Storm Valve

F3060 -5K Vertical Storm Valve
F3060R1 -5K Angle Storm Valve

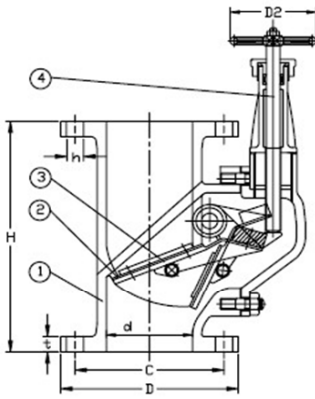

Series F3060

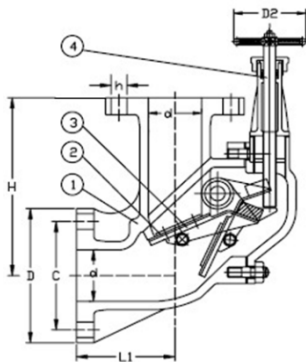

Series F3060R

Technical Feature	
Design Standard	JIS F7426-1996
Test Standard	JIS F7400-1996
Flange Standard	JIS B2220-5K
Application	Used for marine pipelines of Fresh Water, air or gas, Fuel Oil, Lub.oil, and Steam at 205°C or below.

Material				
Part Nr.	Class S		Class B	
1- Body	Cast Steel	SC480	Cast Steel	SC480
2- Seat	Rubber		Rubber	
3- Disc	Stainless Steel	SUS304	Bronze	CAC406
4- Stem	Stainless Steel	SUS403	Brass	C3771BD

Hydraulic Inspection MPa[kgf/cm ²]		
Nominal dia.	Body	Seat
200 or less	1.03[10.5]	0.3[3.0]

Dimension Table											
Size	H		D	C	NO	h	t	L1	D2	Weight[kg]	
	3060	3060R								3060	3060R
50	210	170	130	105	4	15	15	90	100	11.5	13.9
65	240	200	155	130	4	15	15	110	100	16.5	20.1
80	260	220	180	145	4	19	15	120	125	21.6	24.1
100	280	250	200	165	8	19	17	130	125	29.6	35.2
125	330	270	235	200	8	19	17	150	125	43.6	52.7
150	360	310	265	230	8	19	19	165	125	51.6	63.2
200	450	400	320	280	8	23	20	190	125	80.1	83.7

JIS MARINE VALVE

Marine Vertical Storm Valve
Marine Angle Storm Valve

F3060 -10K Vertical Storm Valve
F3060R -10K Angle Storm Valve

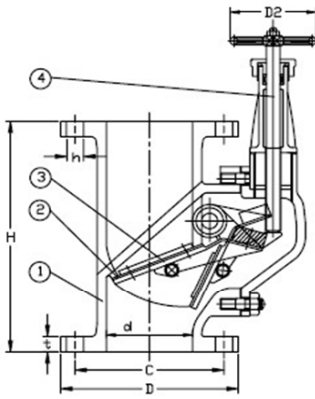

Series F3060

Technical Feature	
Design Standard	JIS F7426-1996
Test Standard	JIS F7400-1996
Flange Standard	JIS B2220-10K
Application	Used for marine pipelines of Fresh Water, air or gas, Fuel Oil, Lub.oil, and Steam at 205°C or below.

Material				
Part Nr.	Class S		Class B	
1- Body	Cast Steel	SC480	Cast Steel	SC480
2- Seat	Rubber		Rubber	
3- Disc	Stainless Steel	SUS304	Bronze	CAC406
4- Stem	Stainless Steel	SUS403	Brass	C3771BD

Hydraulic Inspection MPa[kgf/cm ²]		
Nominal dia.	Body	Seat
200 or less	1.03[10.5]	0.3[3.0]

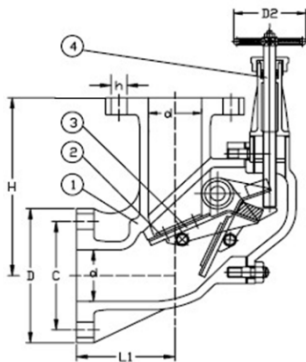

Series F3060R

Dimension Table											
Size	H		D	C	NO	h	t	L1	D2	Weight[kg]	
	3060	3060R								3060	3060R
50	210	170	155	120	4	19	15	90	100	11.5	13.9
65	240	200	175	140	4	19	15	110	100	16.5	20.1
80	260	220	185	150	8	19	15	120	125	21.6	24.1
100	280	250	210	175	8	19	17	130	125	29.6	35.2
125	330	270	250	210	8	23	17	150	125	43.6	52.7
150	360	310	280	240	8	23	19	165	125	51.6	63.2
200	450	400	330	290	12	23	22	190	125	80.1	83.7

MARINE STRAINER AND MUD BOX

Cast Iron Can Water Filter / Simplex Strainer

F7121 5K Can water Filter



Technical Feature	
Design Standard	JIS F7121-1996
Test Standard	JIS F7400-1996
Flange Standard	JIS B2220-5K
Application	Used for marine pipelines of Fresh Water, air or gas, Fuel Oil, Lub.oil, and Steam at 205°C or below

Material List		
Part Nr.	Material	
1- Body	Cast Iron/Mild Steel	FC200/SS400
2- Cover	Cast Iron/Mild Steel	FC200/SS400
3-	Stainless Steel	SUS304
4-Gasket	Non-asbestos	

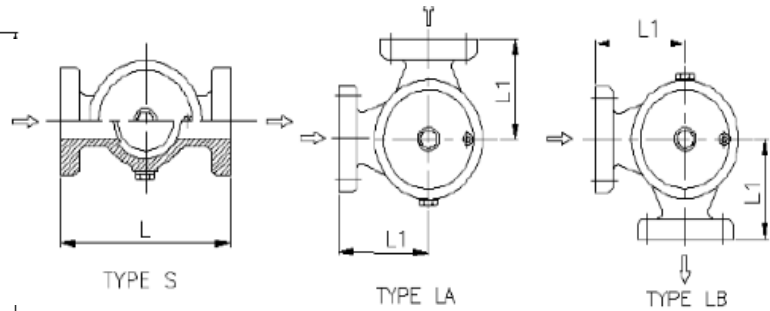
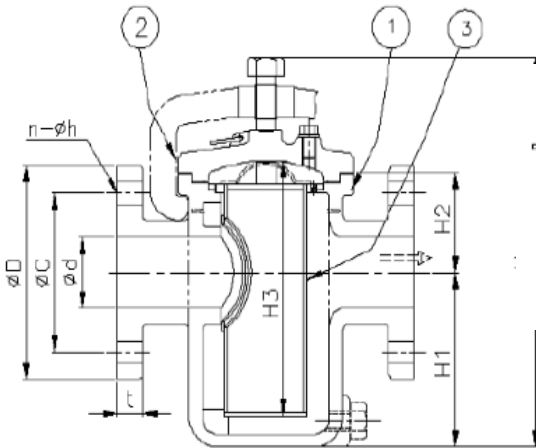

SERIES F 7121 [25A~100A] Water Strainer

Test Pressure MPa		
PN	body	seat
5KG	1.03	0.76

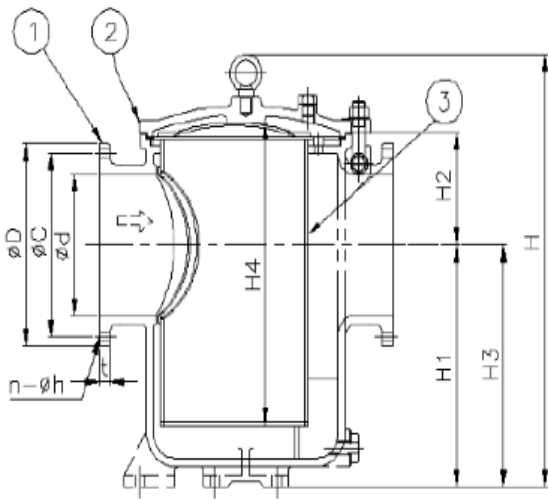

SERIES F 7121 [125A~400A] Water Strainer

Dimension Table-F7121 JIS 5K								
Size	L	D	C	No	h	t	H	Weight
25	170	95	75	4	12	14	180	5.88
32	190	115	90	4	15	16	215	8.23
40	190	120	95	4	15	16	215	8.43
50	200	130	105	4	15	16	240	10.3
65	250	155	130	4	15	18	305	18.5
80	270	180	145	4	19	18	340	24
100	320	200	165	8	19	20	400	35.7
125	400	235	200	8	19	20	485	62.2
150	460	265	230	8	19	20	575	88.6
200	550	320	280	8	23	22	665	141
250	680	385	345	12	23	26	825	246
300	760	430	390	12	23	28	920	321
350	820	480	435	12	25	30	1030	428
400	880	495	495	16	25	30	1135	518

MARINE STRAINER AND MUD BOX

Cast Iron Y Type Strainer

F7220-5K/10K Y TYPE STRAINER

Manufactured in accordance to JIS F7400 , Flanges as per JIS B2220

Technical Feature	
Design Standard	JIS F7220-1996
Test Standard	JIS F7400-1996
Flange Standard	JIS B2220-5K/10K
Application	Used for marine pipelines of Fresh Water, air or gas, Fuel Oil, Lub.oil, and Steam at 205°C or below

Material List		
Part Nr.	Material	
1- Body	Cast Iron	FC200
2- Cover	Cast Iron	FC200
3-	Stainless Steel	SUS304
4-Gasket	Non-asbestos	

Test Pressure MPa		
PN	body	seat
5KG	1.03	0.76
10KG	2.36	1.73

Dimension Table-F7220 JIS 5K							
Size	L	D	C	No	h	t	H
20	200	85	65	4	12	14	127
25	220	95	75	4	12	14	155
32	225	115	90	4	15	16	165
40	260	120	95	4	15	16	180
50	280	130	105	4	15	16	208
65	320	155	130	4	15	18	253
80	350	180	145	4	19	18	268
100	373	200	165	8	19	20	286
125	390	235	200	8	19	20	295
150	410	265	230	8	19	20	318
*200	475	320	280	8	23	22	

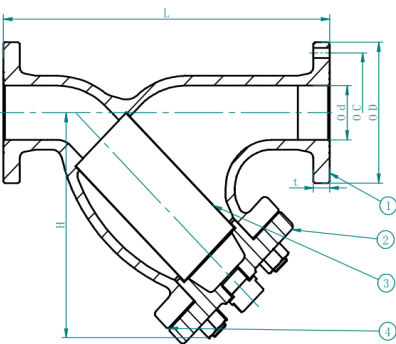

Series F7220

Dimension Table-F7220 JIS 10K							
Size	L	D	C	No	h	t	H
20	200	100	75	4	15	14	127
25	220	125	90	4	19	14	155
32	225	135	100	4	19	16	165
40	260	140	105	4	19	16	180
50	280	155	120	4	19	20	208
65	320	175	140	4	19	22	253
80	350	185	150	8	19	22	268
100	373	210	175	8	19	24	286
125	390	250	210	8	23	24	295
150	410	280	240	8	23	26	318
*200	475	330	290	12	23	26	

JIS MARINE VALVE

SHIP'S DECK STAND FOR CONTROLLING VALVES JIS F3024

Manufactured in accordance to JIS F3024
Flanges as per JIS B2220 5K



Material List		
Part Nr.	Material	
1	Handwheel	FC200
2	Stem	SUS420
3	Check back set	SUS420
4	Body	FC200
5	Indicator	C3771BD
6	Indicator plate	C3771BD
7	Packing gland	FC200
8	Connecting pipe	SC460

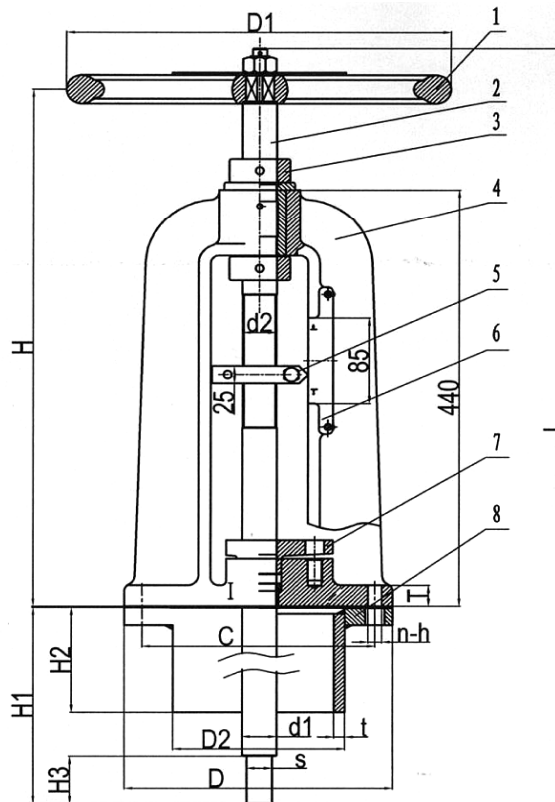

DN	D	C	n-h	T	L	s	d1	d2	D1	weight
25	265	230	8×Ø19	22	840	25	34	M33x2	280	44
32	320	280	8×Ø23	24	854	32	40	M39x3	400	53
40	320	280	8×Ø23	24	861	42	46	M45x3	500	66

JIS MARINE VALVE

DECK STAND CONTROL HEAD WITH INDICATOR CB/T3791-1999

Manufactured in accordance to
CB/T3791



Material List		
Part	Material	
1	Body	SC460
2	Stem	SUS420
3	Indicator stem	SS400
4	welding base plate	SS400

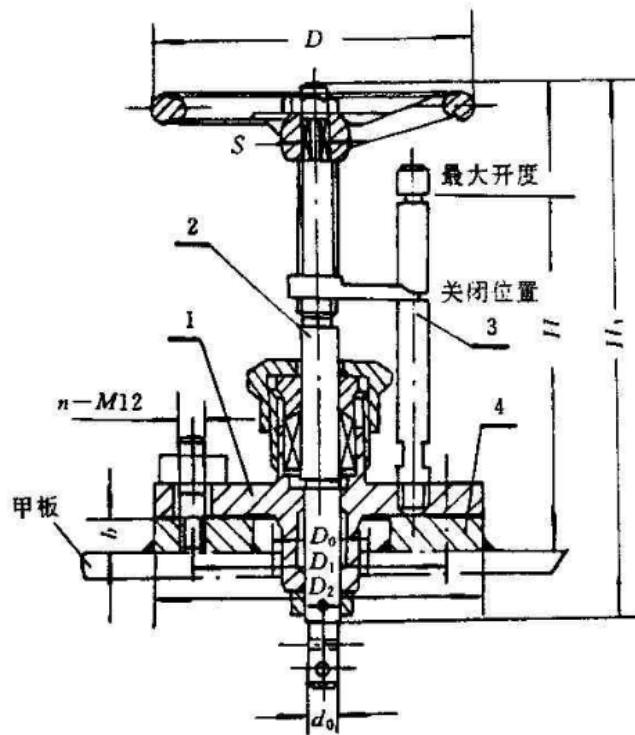

DIMENSION TABLE										
Size	Welded plate				Handwheel		Height		Deck opening	Weight
do	D1	D2	b	n	D	S	H	H1	Do	[kg]
12	94	122	12	4	100	9	162	179	36	2.2
18	94	122	12	4	140	12	177	200	48	3.7
21	94	122	12	4	180	14	202	225	48	4.7

DIN MARINE VALVE

MARINE CAST IRON PRESURE RELIEF VALVE

CB/T3843-1999 PRESSURE RELIEF VALVE

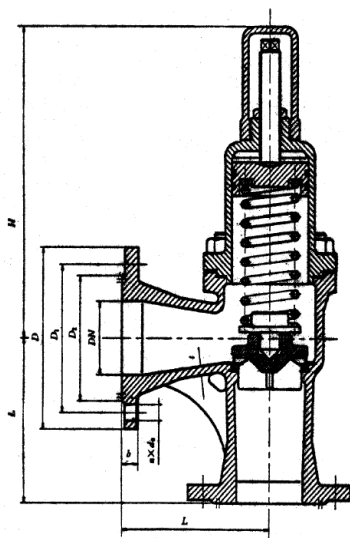

Series CB/T3843-1999

Technical Feature		
Design Standard		CB/T3843-1999
Test Standard		CB3021-1999
Flange Standard		JIS B2220-16K
Face to Face Standard		GB/T11698-2008
Application		Used for overload protection for marine pipelines of fuel oil system.

Material		
Part Nr.	Material	Code
1- Body/honnet	Cast Iron	FC200
2- Disc	Bronze	CAC406
3- Stem	Steel	SS400
4- Spring	Steel	60Si2Ma

Basic Factor	
Nominal Dia	Working Pressure
DN40-100	0..3-0.5 MPa

Dimension Table								
Size	L	H	D	D1	C	NO	b	Weight
								[kg]
40	115	210	120	95	4	15	16	12.3
50	125	230	130	105	4	15	16	16.4
65	145	230	155	130	4	15	16	26.9
80	155	295	180	145	4	19	18	36
100	175	295	200	165	8	19	18	39.7

DIN MARINE VALVE

Cast Iron Gate Valve

DIN3352-F4 Non-rising stem metal seat Gate valve Flat body with T-bolt(F4-S type)



Technical Feature	
Design Standard	DIN3352 -F4
Face to Face	DIN 3202-F4(EN558-1 Series 14)
Flange Standard	DIN2532/2533(EN1092-2)
Test	ISO5208(EN2266)

Valve Parts and Material				
Part Nr.	GG25		GGG40	
1- Body	Cast Iron	GG25	Cast Iron	GGG40
2- Wedge	Cast Iron	GG25	Cast Iron	GGG40
2- Seat Ring	BRASS		Bronze	
3- Disc Ring	BRASS		Bronze	
4- Stem	Stainless Steel	2Cr13	Brass	

Hydraulic Inspection MPa[kgf/cm ²]		
Nominal dia.	Body	Seat
1.0	1.5	1.1
1.6	2.4	1.76

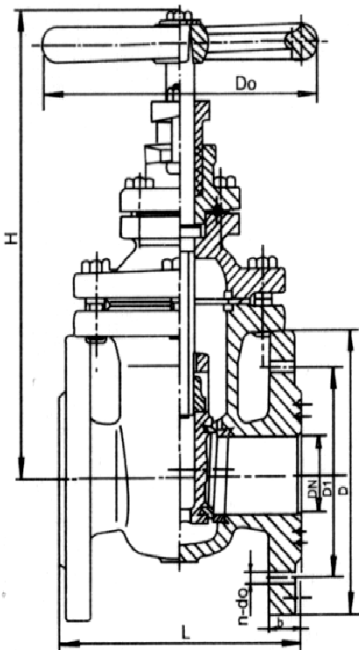

Series DIN3352-F4

Dimension Table-DIN3352-F4										
mm	L	H	D0	D	D1	D2	b	f	N-d0	PN
40	140	246	160	150	110	84	18	3	4-19	PN10 PN16
50	150	263	160	165	125	99	20	3	4-19	
65	170	302	160	185	145	118	20	3	4-19	
80	180	323	160	200	160	132	22	3	8-19	
100	190	380	200	220	180	156	22	3	8-19	
125	200	435	250	250	210	184	24	3	8-19	
150	210	488	250	285	240	211	24	3	8-23	PN10
200	230	574	250	340	295	266	26	3	8-23	
250	250	688	320	395	350	319	28	3	12-23	
300	270	790	320	445	400	370	28	4	12-23	PN4
350	290	884	360	505	460	429	30	4	16-23	
400	310	995	360	565	515	480	32	4	16-28	
450	330	1093	360	565	515	480	32	4	20-28	
500	350	1188	500	670	620	582	34	4	20-28	

DIN MARINE VALVE

Cast Iron Globe/Angle(SDNR) Valve

GB/T590 &GB/T591 AS Globe(SDNR) Valve

GB/T590 &GB/T591 BS Anlge(SDNR) Valve

Face to Face accoridng to DIN3202-F1/F32

Flanges as per GB/T2501(DIN2501)

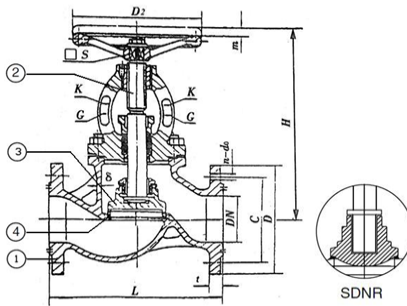

GB/T 590/591 AS
(DIN86251&86252 A)
FIG.241/241LK
FIG.268/268LK

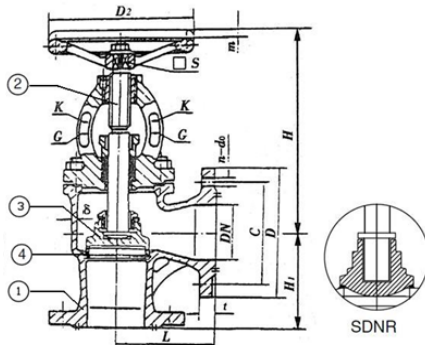

GB/T 590/591 BS
(DIN86251&86252 B)
FIG.242/242LK
FIG.269/269LK

Material List		
Part Nr.	Material	
	FIG.241/242	FIG.268/269
1- Body	Cast Iron	Cast Iron
2- Stem	Stainless Steel	Brass
3- Disc	Stainless Steel	Bronze
4- Seat	Stainless Steel	Bronze

Hydraulic Inspection		
NP	Test Pressure MPa	
	Body	Seat
16	2.4	1.76
10	1.5	1.1

Dimension Table								
PN	DN	Flange Dia			AS Type		BS Type	
		D	C	n-d	L	WT. kg	L1	WT. kg
16	15	95	65	4×Φ14	130	6.2	90	5.7
	20	105	75	4×Φ14	150	6.2	95	5.7
	25	115	85	4×Φ14	160	6.6	100	6.4
	32	140	100	4×Φ18	180	8.6	105	8.7
	40	150	110	4×Φ18	200	11	115	10.7
16 (10)	50	165	125	4×Φ18	230	14.2	125	14.2
	65	185	145	4×Φ18	290	21.6	145	20.1
	80	200	160	8×Φ18	310	26	155	23.9
	100	220	180	8×Φ18	350	35	175	32.8
	125	250	210	8×Φ18	400	44.3	200	44.8
16	150	285	240	8×Φ22	480	62.7	225	59.8
	200	340	295	12×Φ22	600	105	275	99.6
	250	405	355	12×Φ26	730	158	325	153
10	300	460	410	12×Φ26	850	219	375	208
	200	340	295	8×Φ22	600	105	275	99.6
	250	395	350	12×Φ22	730	151	325	153
	300	445	400	12×Φ22	850	219	375	208

DIN MARINE VALVE Cast Iron Lift Check Valve

GB/T592 AS Lift Globe Valve GB/T592 BS Lift Anlge Valve

Face to Face accordng to DIN3202-F1/F32
Flanges as per GB/T2501(DIN2501)

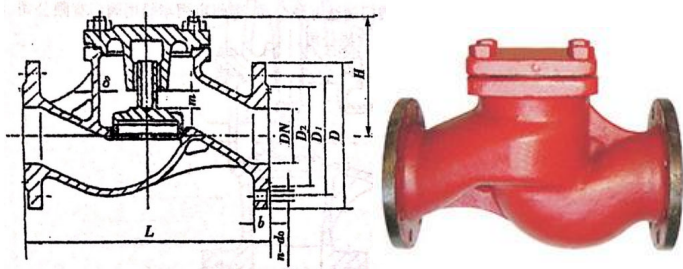

GB/T 592 AS

(DIN86253&86262 A)
FIG.77, FIG.101

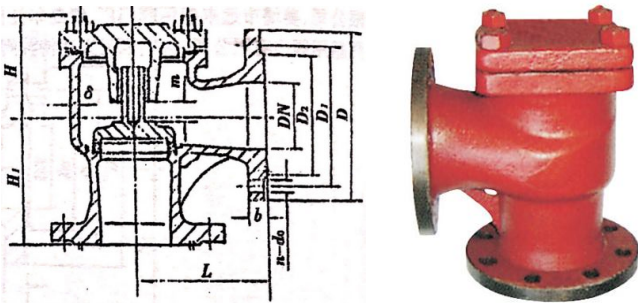

GB/T 592 BS

(DIN86252&86262 B)
FIG.78, FIG.102

Material List		
Part Nr.	Material	
	FIG.77/78	FIG.101/102
1- Body	Cast Iron	Cast Iron
2- Stem	Stainless Steel	Brass
3- Disc	Stainless Steel	Bronze
4- Seat	Stainless Steel	Bronze

Hydraulic Inspection		
NP	Test Pressure MPa	
	Body	Seat
16	2.4	1.76
10	1.5	1.1

Dimension Table								
PN	DN	Flange Dia			AS Type		BS Type	
		D	C	n-d	L	WT. kg	L1	WT. kg
16	15	95	65	4×Φ14	130	4.8	90	5
	20	105	75	4×Φ14	150	4.8	95	5
	25	115	85	4×Φ14	160	5.1	100	5.3
	32	140	100	4×Φ18	180	7.1	105	7.3
	40	150	110	4×Φ18	200	9.3	115	9.7
	50	165	125	4×Φ18	230	11.4	125	12
16 (10)	65	185	145	4×Φ18	290	18.1	145	19
	80	200	160	8×Φ18	310	21.6	155	22.7
	100	220	180	8×Φ18	350	29.2	175	30.8
	125	250	210	8×Φ18	400	40.2	200	42.3
	150	285	240	8×Φ22	480	56.4	225	60.8

SERIES GB/T587 & 588 AS/BS PN 25/16/10/6

DIN Bronze Globe(SDNR) Valve

DIN Bronze Angle(SDNR) Valve

Face to Face accordance to GB/T11698 (DIN3202-F1/F32)

Flanges as per GB/T2501(DIN2501)

STRAIGHT TYPE:GB/T 587 & 588 AS

(DIN86260&86261 A)

DIN MODEL No.:

FIG.1270DIN/1271DINLK: Bronze/Brass

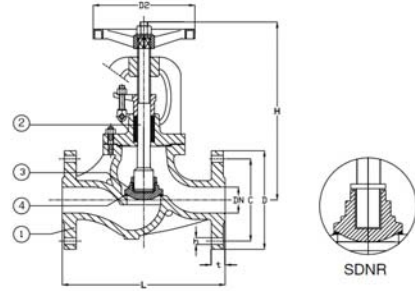

ANGLE TYPE: GB/T 587 & 588 BS

(DIN86260&86261 B)

DIN MODEL No.:

FIG.1271DIN/1271DINLK: Bronze/Brass

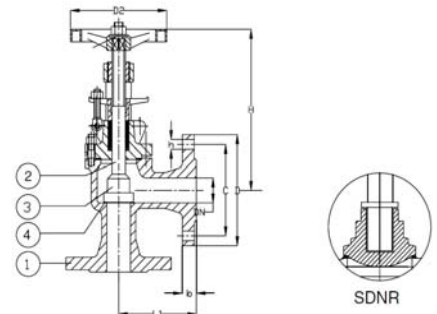

Note: LK=SDNR type

Part Nr.	Material	Material
1- Body	Bronze	Brass
2- Stem	Brass	Brass
3-Disc	Bronze	Brass
4-Seat	Bronze	Brass

SIZE DN	TEST PRESSURE[MPa]		
	PN	body	seat
15-125	25	3.75	2.75
15-150	16	2.4	1.76
200-300	10	1.5	1.1
15-150	6	0.9	0.66

PN	DN	Flange Dia			STRAIGHT TYPE-AS			ANGLE TYPE-BS		
		D	C	n-d	L	KG	IMPA CODE 1270DIN	L	KG	IMPA CODE 1271DIN
25 (16)	15	95	65	4×Φ14	130	5	755201	90	5.2	755216
	20	105	75	4×Φ14	150	5.5	755202	95	5.6	755217
	25	115	85	4×Φ14	160	6	755203	100	6.4	755218
	32	140	100	4×Φ18	180	8	755204	105	8.5	755219
	40	150	110	4×Φ18	200	10	755205	115	10.4	755220
25	50	165	125	4×Φ18	230	12	755206	125	14.1	755221
	65	185	145	8×Φ18	290	21	GB/T Standard	145	19.8	GB/T Standard
	80	200	160	8×Φ18	310	29		155	27.9	
	100	235	190	8×Φ22	350	46.4		175	41.2	
125	270	220	8×Φ26	400	76.2	200		62.1		
16	65	185	145	4×Φ18	290	17	755207	145	19.6	755222
	80	200	160	8×Φ18	310	23	755208	155	27.7	755223
	100	220	180	8×Φ18	350	30	755209	175	40.6	755224
	125	250	210	8×Φ18	400	50	755210	200	51.9	755225
	150	285	240	8×Φ22	480	65	755211	225	69.2	755226
10	200	340	295	8×Φ22	600	110	755213	275	95	755228
	250	395	350	12×Φ22	730	165	755214	325	155	755229
	300	445	400	12×Φ22	850	295	755215	375	225	755230
6	15	80	55	4×Φ11	130	3.9	GB/T Standard	90	4	GB/T Standard
	20	90	65	4×Φ11	150	4.7		95	4.5	
	25	100	75	4×Φ11	160	5.4		100	5.1	
	32	120	90	4×Φ14	180	6.6		105	6.4	
	40	130	100	4×Φ14	200	8.7		115	8.4	
	50	140	110	4×Φ14	230	11		125	10.5	
	65	160	130	4×Φ14	290	17.1		145	15.8	
	80	190	150	4×Φ18	310	22.6		155	21.7	
	100	210	170	4×Φ18	350	33.7		175	29.9	
	125	240	200	8×Φ18	400	45.4		200	44.4	
150	265	225	8×Φ18	480	67.9	225	62.9			

SERIES GB/T584 & 585 AS/BS PN 64/40/25/16/10

DIN Cast Steel Globe(SDNR) Valve

DIN Cast Steel Angle(SDNR) Valve

Face to Face accordance to GB/T11698 (DIN3202-F1/F2/F32)

Flanges as per GB/T2501(DIN2501)

STRAIGHT TYPE:GB/T 584 & 585 AS

(DIN86251&86252 A)

DIN MODEL No.:

FIG.398/398LK: SC/BC

FIG.417/417LK: SC/SUS

FIG.1202: SC/SUS



ANGLE TYPE: GB/T 584 & 585 BS

(DIN86251&86252 B)

DIN MODEL No.:

FIG.399/399LK: SC/BC

FIG.418/418LK: SC/SUS

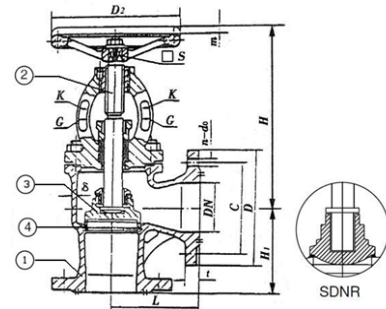
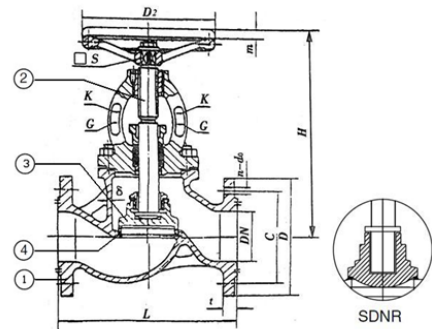

Note: LK=SDNR type

Part Nr.	Material		
	FIG.398/399	FIG.417/418	FIG.1202
1- Body	Cast Steel	Cast Steel	Forged/Cast Steel
2- Stem	Brass	Stainless Steel	Stainless Steel
3- Disc	Bronze	Stainless Steel	Stainless Steel
4- Seat	Bronze	Stainless Steel	Stainless Steel

SIZE		TEST PRESSURE[MPa]	
DN	PN	body	seat
15-300	25	3.75	2.75
15-300	16	2.4	1.76
200-300	10	1.5	1.1

PN	DN	Flange Dia			STRAIGHT TYPE-AS					ANGLE TYPE-BS			
		D	C	n-d	L	WT. kg	IMPA CODE			L1	WT. kg	IMPA CODE	
							398-PN16	417-PN25/40	1202-PN40/64			399-PN16	418-PN25/40
64	15	105	75	4×Φ14	210	9.3	-	-	755465	115	8.1	-	-
	20	130	90	4×Φ18	230	9.3	-	-	755466	115	10	-	-
	25	140	100	4×Φ18	230	11	-	-	755467	115	12.2	-	-
	32	155	110	4×Φ22	260	13.1	-	-	755468	130	12.2	-	-
	40	170	125	4×Φ22	260	21.7	-	-	755469	130	20.6	-	-
	50	180	135	4×Φ22	300	27.2	-	-	755470	150	25.8	-	-
40 (25) (16)	15	95	65	4×Φ14	130	5.4	755194	755326	755452	90	5.4	755294	755341
	20	105	75	4×Φ14	150	5.4	755195	755327	755453	95	5.4	755295	755342
	25	115	85	4×Φ14	160	6.2	755196	755328	755454	100	6.1	755296	755343
	32	140	100	4×Φ18	180	8.4	755197	755329	755455	105	8.3	755297	755344
	40	150	110	4×Φ18	200	11.2	755198	755330	755456	115	10.9	755298	755345
	50	165	125	4×Φ18	230	14.5	755199	755331	755457	125	14.2	755299	755346
40 (25)	65	185	145	8×Φ18	290	28.9	-	755332	755458	145	20.6	-	755347
	80	200	160	8×Φ18	310	24.8	-	755333	755459	155	25.8	-	755348
	100	235	190	8×Φ22	350	40.1	-	755334	755460	175	37.8	-	755349
	125	270	220	8×Φ26	400	60.3	-	755335	755461	200	58.1	-	755350
	150	300	250	8×Φ26	480	79.9	-	755336	755462	225	73.7	-	755351
16	65	185	145	4×Φ18	290	21.2	755201	-	-	145	19.9	755315	-
	80	200	160	8×Φ18	310	27.6	755202	-	-	155	24.5	755316	-
	100	220	180	8×Φ18	350	39.4	755203	-	-	175	36.2	755317	-
	125	250	210	8×Φ18	400	50.5	755204	-	-	200	46.1	755318	-
	150	285	240	8×Φ22	480	67.3	755205	-	-	225	62.1	755319	-
	200	340	295	12×Φ22	600	121	755207	-	-	275	116	755321	-
	250	405	355	12×Φ26	730	180	755208	-	-	325	173	755322	-
300	460	410	12×Φ26	850	225	755209	-	-	375	216	755323	-	
10	200	340	295	8×Φ22	600	109	GB/T	-	-	275	104	GB/T	-
	250	395	350	12×Φ22	730	167	Standard	-	-	325	160	Standard	-
	300	445	400	12×Φ22	850	225	-	-	-	375	216	-	-

JIS MARINE VALVE Cast Iron Foot Valve

H42X-5K Foot Valves H42X-10K Foot Valves

Manufactured in accordance to H42X
Flanges as per JIS B2220 5K/10K

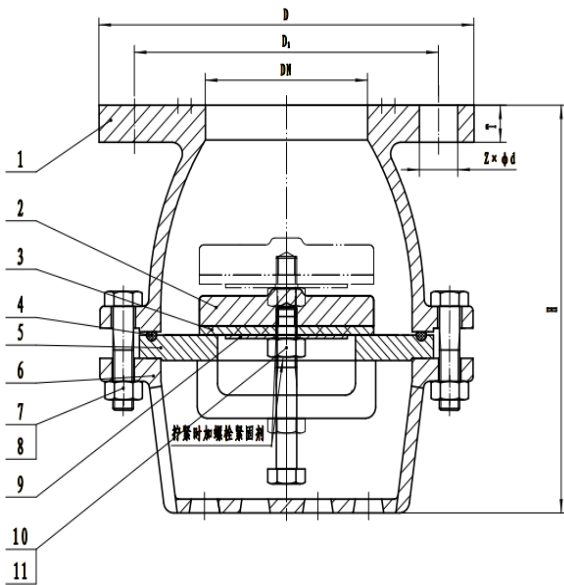

Cast Iron Foot Valve H42X

Material List		
Part Nr.	Material	Materail Code
1- Body	Cast Iron	FC200
2- Cover	Cast Iron	FC200
3- Seat	Cast Iron	FC200
4- Disc	Cast Iron	FC200

Hydraulic Inspection			
Nominal Pressure		5K	10K
Hydraulic Inspection	Body	10.5kg	21kg
	Seat	7.7kg	15.4kg

Dimension Table JIS 5K						
DN	H	D	C	Z	d	T
50	162	130	105	4	15	14
65	167	155	130	4	15	14
80	177	180	145	4	19	16
100	206	200	165	8	19	18
125	256	235	200	8	19	20
150	302	265	230	8	19	20

Dimension Table JIS 10K						
DN	H	D	D1	Z	d	T
50	162	155	120	4	19	14
65	167	175	140	4	19	14
80	177	185	150	8	19	16
100	206	210	175	8	19	18
125	256	250	210	8	23	20
150	302	280	240	8	23	20

HAND PUMPS

Cast Iron Semi-Rotary Hand Pump

Series K Model Hand Pump

K series semi-rotary hand pumps are suitable for the handling of clear and light liquids such as water, petrol, diesel and all fuels, paraffin, alcohol, light chemical solutions and edible oils.

Material List	
1. BODY	Cast Iron
2.VANES	Alloy or Brass
3.SHAFT	Steel
4.SEALS	Graphite

Performance Feature						
Size	Double Strokes (per min)	Flow rate (LPM)	Flow rate (GPM)	Distance (max m)	Delivery (head feet)	Suction distance (m)
K-00	80	7.5	1.65	25	82	5
K-0	65	11.5	2.5	25	82	5
K-1	60	17.25	3.75	25	82	5
K-2	55	22.5	5	25	82	6
K-3	50	29	6.5	22	72	6
K-4	50	43.25	9.5	22	72	6
K-5	45	53.5	11.75	20	66	6.5
K-7	40	90	19.8	15	49	6.5



Serial K Model

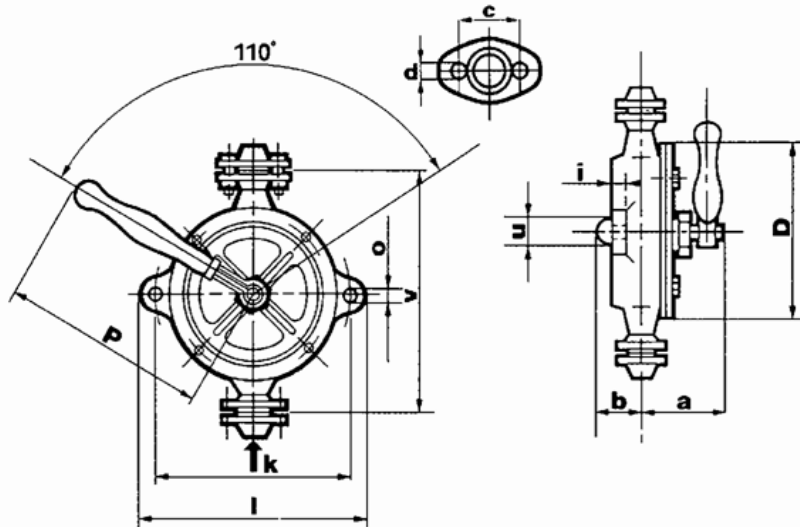

Dimension Table-Series K model

Size	In/Out BSP	D	a	b	i	k	v	l	o	p	u	c	d	Weight
K-00	3/8"	100	90	45	7.5	98	110	120	7	220	32	-	-	3.2
K-0	1/2"	135	140	55	10	130	175	160	13	300	25	55	9.5	5.1
K-1	3/4"	150	140	55	10	150	205	180	13	300	25	65	9.5	6.1
K-2	1"	170	145	60	10	170	230	200	13	360	30	75	9.5	8.8
K-3	1 1/4"	200	170	62	12	200	275	240	13	450	30	90	14	11.5
K-4	1 1/4"	220	190	74	12	220	295	255	13	500	30	90	14	12.6
K-5	1 1/2"	245	200	76	12	240	320	275	13	600	35	100	14	16
K-7	2"	288	273	72	15	310	360	360	15	620	50	100	15	32

AIR VENT HEAD/AIR PIPE HEAD JIS CAST IRON AIR VENT HEAD

JIS KS91A-121 AIR PIPE HEAD (VENT CHECK VALVE)

Manufactured according to the requirement of IACS UR P3(Rev.4 Jan 2016)-Air pipe closing devices.
Flanges as per JIS B2220 5K

Material List		
Part Number	Materials	Remark
1 - Body	Cast Iron	GG20
2 - Top Cover	Galvanized steel	SS400
3 - bolt	Stainless steel	SUS201
4 - Guide bolt	Stainless steel	SUS304
5 - Wire Net	Stainless steel	SUS304
6 - Disc Float	Stainless steel	SUS304
7 - Cushion	NBR	
8 - Side Cover	Galvanized steel	SS400
9 - Cushion	NBR	
10 - Bolt	Stainless steel	SUS201
11 - Gasket	NBR	
12 - Seat Ring	NBR	

Option of Side Cover:

Open Side Cover

Closed Side Cover

For Water/Ballast Tank

For OIL, Fuel Oil Tank



Dimension Table							
DN	H	A	B	T	D	C	Hole
50	168	169	125	5.5	130	105	4×Φ15
65	184	183	135	5.5	155	130	4×Φ15
80	207	219	146	6.0	180	145	4×Φ19
100	200	230	230	7.0	200	165	8×Φ19
125	220	248	258	7.0	235	200	8×Φ19
150	248	289	288	8.0	265	230	8×Φ19
200	288	349	340	8.5	320	280	8×Φ23
250	367	416	450	9.0	385	345	12×Φ23
300	425	504	535	9.5	430	390	12×Φ23
350	515	641	620	11.5	480	435	12×Φ25
400	570	700	714	11.5	540	495	16×Φ25
450	646	790	749	11.5	605	555	16×Φ25

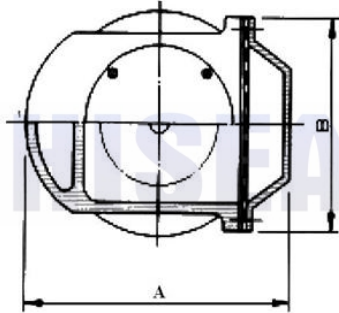
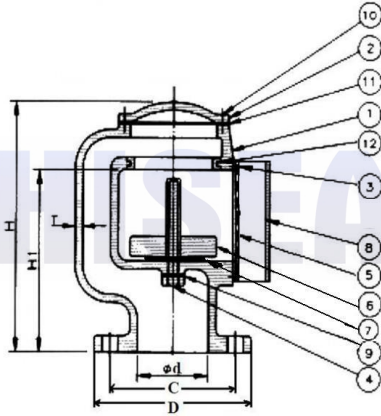

DN50 - DN80

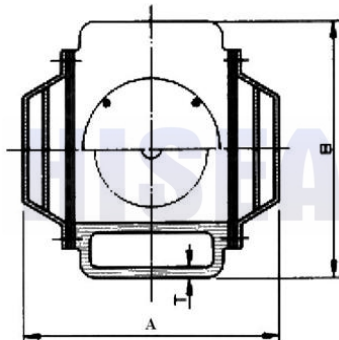
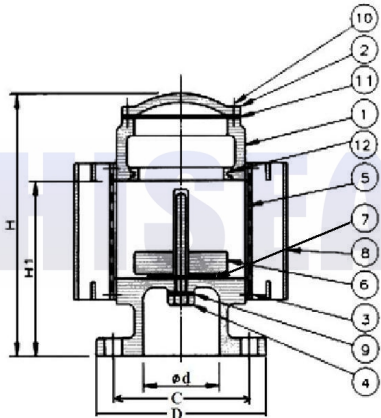

DN100 - DN450

AIR VENT HEAD/AIR PIPE HEAD DIN CAST IRON AIR VENT HEAD

Manufactured according to the requirement of IACS UR P3(Rev.4 Jan 2016)-Air pipe closing devices.
Flanges as per DIN2501-PN10

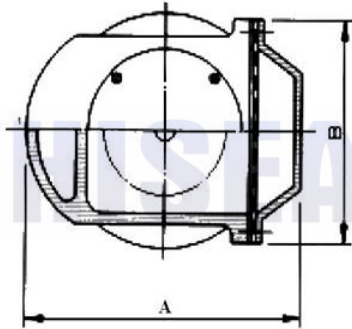
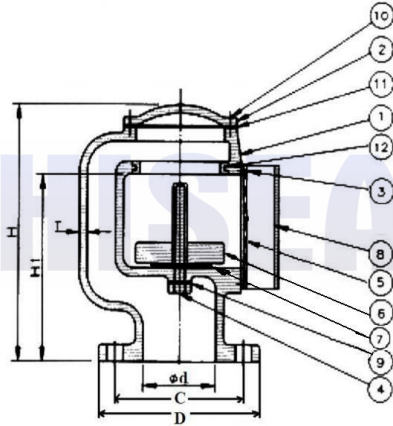

DN50 - DN80

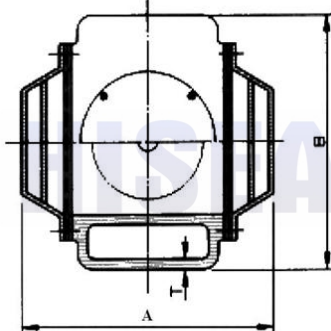
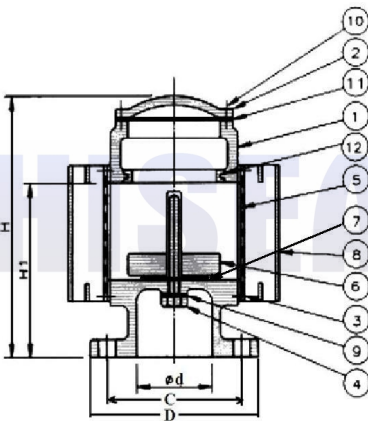

DN100 - DN450

DIN3594 PN10 AIR PIPE HEAD (VENT CHECK VALVE)

Material List		
Part Number	Materials	Remark
1 - Body	Cast Iron	GG20
2 - Top Cover	Galvanized steel	SS400
3 - bolt	Stainless steel	SUS201
4 - Guide bolt	Stainless steel	SUS304
5 - Wire Net	Stainless steel	SUS304
6 - Disc Float	Stainless steel	SUS304
7 - Cushion	NBR	
8 - Side Cover	Galvanized steel	SS400
9 - Cushion	NBR	
10 - Bolt	Stainless steel	SUS201
11 - Gasket	NBR	
12 - Seat Ring	NBR	

Option of Side Cover:

Open Side Cover

Closed Side Cover

For Water/Ballast Tank

For OIL, Fuel Oil Tank



Dimension Table							
DN	H	A	B	T	D	C	Hole
50	168	169	125	5.5	165	125	4×Φ18
65	184	183	135	5.5	185	145	4×Φ18
80	207	219	146	6.0	200	160	8×Φ18
100	200	230	230	7.0	220	180	8×Φ18
125	220	248	258	7.0	250	210	8×Φ18
150	248	289	288	8.0	285	240	8×Φ22
200	288	349	340	8.5	340	295	8×Φ22
250	367	416	450	9.0	395	350	12×Φ22
300	425	504	535	9.5	445	400	12×Φ22
350	515	641	620	11.5	505	460	16×Φ22
400	570	700	714	11.5	565	515	16×Φ26
450	646	790	749	11.5	615	565	20×Φ26

AIR VENT HEAD/AIR PIPE HEAD JIS CAST IRON AIR VENT HEAD

Manufactured according to the requirement of IACS UR P3(Rev.4 Jan 2016)-Air pipe closing devices.
Flanges as per JIS B2220 5K

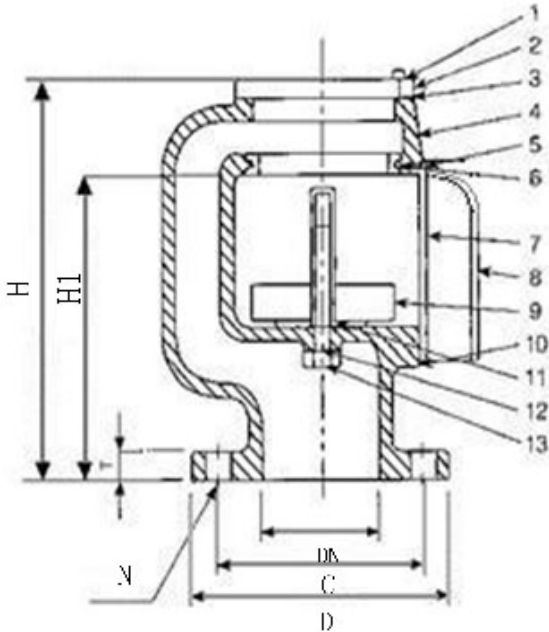

DN50-DN200



53-ON AIR PIPE HEAD (VENT CHECK VALVE)

Material List		
Part Number	Materials	Remark
1 - bolt	Stainless steel	SUS201
2 - Top Cover	Galvanized steel	SS400
3 - Gasket	NBR	
4 - Body	Cast Iron	GG20
5 - Bolt	Stainless steel	SUS201
6 - Seat Ring	NBR	
7 - Wire Net	Stainless steel	SUS304
8 - Side Cover	Galvanized steel	SS400
9 - Disc Float	Stainless steel	SUS304
10 - Bolt	Stainless steel	SUS201
11 - Cushion	NBR	
12 - Cushion	NBR	
13 - Guide bolt	Stainless steel	SUS304

Option of Side Cover:

Open Side Cover
For Water/Ballast Tank

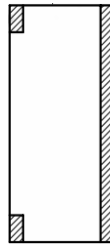

Dimension Table

DN	H	H1	T	a	D	C	Hole
50	179	131	14.0	7.0	130	105	4×Φ15
65	199	144	14.0	7.0	155	130	4×Φ15
80	220	154	14.0	7.0	180	145	4×Φ19
100	260	170	16.0	8.0	200	165	8×Φ19
125	299	203	16.0	8.0	235	200	8×Φ19
150	334	231	18.0	9.0	265	230	8×Φ19
200	420	291	18.0	9.0	320	280	8×Φ23

HISEA QINGDAO HISEA MACHINERY EQUIPMENT CO.,LTD.

AIR VENT HEAD/AIR PIPE HEAD GB/T CAST IRON AIR VENT HEAD

GB/T3594 (E D) PN6 AIR PIPE HEAD (VENT CHECK VALVE)

Manufactured according to the requirement of IACS UR P3(Rev.4 Jan 2016)-Air pipe closing devices.

Material List		
Part Number	Materials	Remark
1 - Body	Cast Iron	GG20
2 - Top Cover	Galvanized steel	SS400
3 - bolt	Stainless steel	SUS201
4 - Guide bolt	Stainless steel	SUS304
5 - Wire Net	Stainless steel	SUS304
6 - Disc Float	Stainless steel	SUS304
7 - Cushion	NBR	
8 - Side Cover	Galvanized steel	SS400
9 - Cushion	NBR	
10 - Bolt	Stainless steel	SUS201
11 - Gasket	NBR	
12 - Seat Ring	NBR	

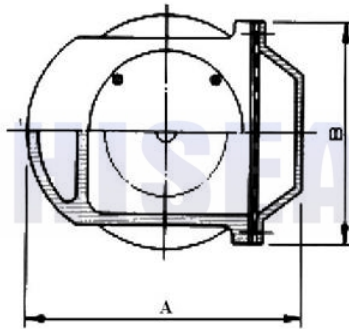
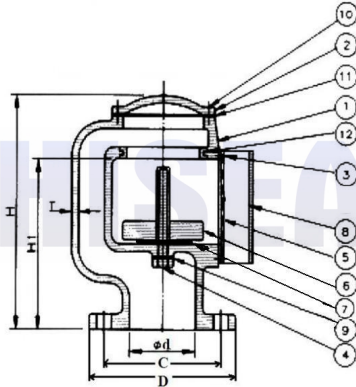

DN50 - DN80

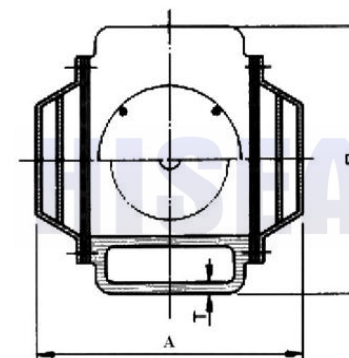
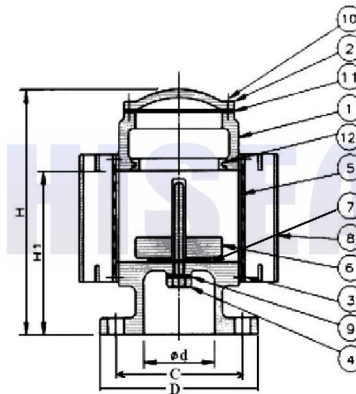

DN100 - DN450

Option of Side Cover:

Open Side Cover
For Water/Ballast Tank

Closed Side Cover
For OIL, Fuel Oil Tank



Remark: ES for Ballast tank, DS for Oil tank

Dimension Table								
DN	H	A	B	T	D	D1	C	Hole
50	168	169	125	5.5	135	103	84	6×Φ15
65	184	183	135	5.5	155	123	104	6×Φ15
80	207	219	146	6.0	170	138	118	8×Φ15
100	200	230	230	7.0	190	158	138	8×Φ15
125	220	248	258	7.0	215	183	164	10×Φ15
150	248	289	288	8.0	240	208	190	12×Φ15
200	288	349	340	8.5	295	264	247	12×Φ15
250	367	416	450	9.0	365	327	306	14×Φ17
300	425	504	535	9.5	430	386	360	14×Φ21
350	515	641	620	11.5	480	436	410	16×Φ21
400	570	700	714	11.5	530	486	460	16×Φ21
450	646	790	749	11.5	580	536	512	18×Φ21

AIR VENT HEAD/AIR PIPE HEAD GB/T CAST IRON AIR VENT HEAD

GB/T3594 (ES DS) PN6 AIR PIPE HEAD (VENT CHECK VALVE)

Manufactured according to the requirement of IACS UR P3(Rev.4 Jan 2016)-Air pipe closing devices. Flanges as per GB/T2501-PN6 PN10

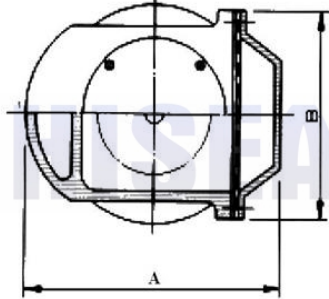
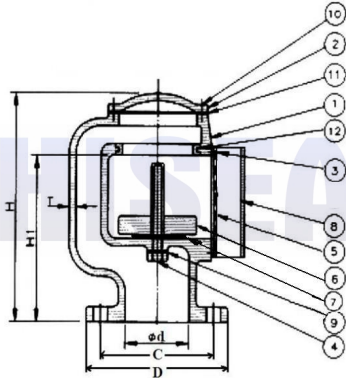

DN50 - DN80

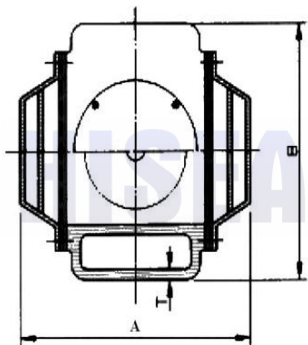
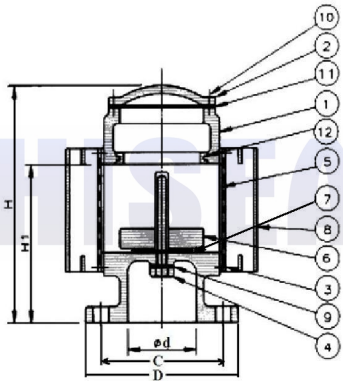

DN100 - DN450

Material List		
Part Number	Materials	Remark
1 - Body	Cast Iron	GG20
2 - Top Cover	Galvanized steel	SS400
3 - bolt	Stainless steel	SUS201
4 - Guide bolt	Stainless steel	SUS304
5 - Wire Net	Stainless steel	SUS304
6 - Disc Float	Stainless steel	SUS304
7 - Cushion	NBR	
8 - Side Cover	Galvanized steel	SS400
9 - Cushion	NBR	
10 - Bolt	Stainless steel	SUS201
11 - Gasket	NBR	
12 - Seat Ring	NBR	

Option of Side Cover:

Open Side Cover

Closed Side Cover

For Water/Ballast Tank

For OIL, Fuel Oil Tank



Remark: ES for Ballast tank, DS for Oil tank

Dimension Table										
DN	H	A	B	T	PN6			PN10		
					D	C	Hole	D	C	Hole
50	168	169	125	5.5	140	110	4×Φ14	165	125	4×Φ18
65	184	183	135	5.5	160	130	4×Φ14	185	145	4×Φ18
80	207	219	146	6.0	190	150	4×Φ18	200	160	8×Φ18
100	200	230	230	7.0	210	170	4×Φ18	220	180	8×Φ18
125	220	248	258	7.0	240	200	8×Φ18	250	210	8×Φ18
150	248	289	288	8.0	265	225	8×Φ18	285	240	8×Φ22
200	288	349	340	8.5	320	280	8×Φ18	340	295	8×Φ22
250	367	416	450	9.0	375	335	12×Φ18	395	350	12×Φ22
300	425	504	535	9.5	440	395	12×Φ22	445	400	12×Φ22
350	515	641	620	11.5	490	445	12×Φ22	505	460	16×Φ22
400	570	700	714	11.5	540	495	16×Φ22	565	515	16×Φ26
450	646	790	749	11.5	595	550	16×Φ22	615	565	20×Φ26

BUTTERFLY VALVE

JIS Butterfly valve-wafer type

F7480 5K&10K, PN10&PN16, Class150

Face To Face - ISO5752-Series 20 (JIS B2002 46#)

Manufactured in accordance to JIS F7480

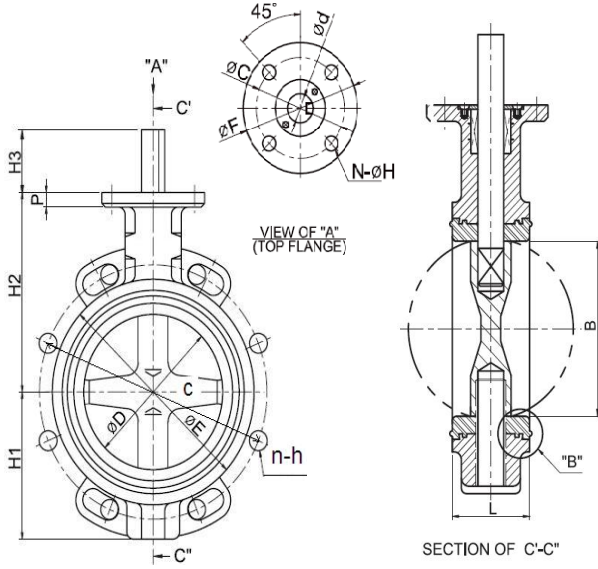

Standard Specification		
Face to Face dimension	ISO5752 (20#), JIS B2002 46#	
Body design	Wafer Type	
Valve Size	50-300	350-500
Top flange	ISO5211	
Flange Standard	5K/10K, 150lb, PN10 PN16	
Max.Working Pressure	1.0 Mpa	
Working temp.	NBR:-10-80℃, EPDM:-20-120℃	
Material	Body	Ductile Iron, Cast Iron, Cast Steel
	Disc	SUS304(SCS13), SUS316(SCS14)
	Seat	NBR, EPDM
	Stem	SUS420J2, SUS416
Actuators	lock lever	50-200
	Worm gear	✓
	Centre handle	✓
	Pneumatic	✓
	Motorized	✓

(unit : mm)

Dimensions

SIZE	TOP FLANGE & STEM									OUT LINE DIMENSION					
	Ød	P	ØC	N	H	T	ØF	H3	ISO 5211	L	ØD	H1	H2	ØE	B
50A	14.0	14	70	4	9	11	90	15.2	F07	43.0	52.0	75.0	130.0	93	49.0
65A	14.0	14	70	4	9	11	90	15.2	F07	46.0	67.0	80.0	137.0	108	64.0
80A	14.0	14	70	4	9	11	90	15.2	F07	46.0	80.0	84.0	156.0	122	77.0
100A	16.0	16	70	4	9	14	90	17.7	F07	52.0	100.0	110.0	170.0	150	97.0
125A	18.0	16	70	4	9	14	90	17.7	F07	56.0	125.0	123.0	185.0	180	122.0
150A	18.0	16	70	4	9	14	90	17.7	F07	56.0	150.5	143.0	203.0	208	148.0
200A	22.0	17	70	4	9	17	90	20.5	F07	60.0	196.5	168.0	238.0	259	193.5
250A	25.4	20	102	4	11	22	125	20.5	F10	68.0	247.0	203.0	270.0	318	244.4
300A	28.0	20	102	4	11	22	125	24.1	F10	78.0	295.5	242.0	310.0	370	293.0
350A	28.0	20	102	4	12		125	70.0	F10	78.0	330.0	264.5	345.5	415	326.0
400A	32.0	23	140	4	18		175	80.0	F14	102.0	379.0	298.5	349.5	468	376.5
450A	38.0	23	140	4	18		175	80.0	F14	114.0	437.0	350.0	400.0	527	434.0
500A	45.0	23	165	4	22		210	90.0	F16	127.0	490.0	380.0	440.0	578	486.0

(unit : mm)

Flange Drilling Table

SIZE	PN 10			PN 16			ANSI 150 LBS			JIS 5K			JIS 10K		
	c	n	h	c	n	h	c	n	h	c	n	h	c	n	h
50A	125.0	4	18.0	125.0	4	18.0	120.7	4	19.1	105.0	4	15.0	120.0	4	19.0
65A	145.0	4	18.0	145.0	4	18.0	139.7	4	19.1	130.0	4	15.0	140.0	4	19.0
80A	160.0	8	18.0	160.0	8	18.0	152.4	4	19.1	145.0	4	19.0	150.0	8	19.0
100A	180.0	8	18.0	180.0	8	18.0	190.5	8	19.1	165.0	8	19.0	175.0	8	19.0
125A	210.0	8	18.0	210.0	8	18.0	215.9	8	22.2	200.0	8	19.0	210.0	8	23.0
150A	240.0	8	22.0	240.0	8	22.0	241.3	8	22.2	230.0	8	19.0	240.0	8	23.0
200A	295.0	8	22.0	295.0	12	22.0	298.5	8	22.2	280.0	8	23.0	290.0	12	23.0
250A	350.0	12	22.0	355.0	12	26.0	362.0	12	25.4	345.0	12	23.0	355.0	12	25.0
300A	400.0	12	22.0	410.0	12	26.0	431.8	12	25.4	390.0	12	23.0	400.0	16	25.0
350A	460.0	16	22.0	470.0	16	26.0	476.3	12	28.6	435.0	12	25.0	445.0	16	25.0
400A	515.0	16	26.0	525.0	16	30.0	539.8	16	28.6				510.0	16	27.0
450A	565.0	20	26.0	585.0	20	30.0	577.9	16	31.8				565.0	20	27.0
500A	620.0	20	26.0	650.0	20	33.0	635.0	20	31.8				620.0	20	27.0

BUTTERFLY VALVE

JIS Butterfly valve-Lug type

Face To Face - ISO5752-Series 20 (JIS B2002 46#)

F7480 5K&10K, PN10&PN16, Class150

Manufactured in accordance to JIS F7480

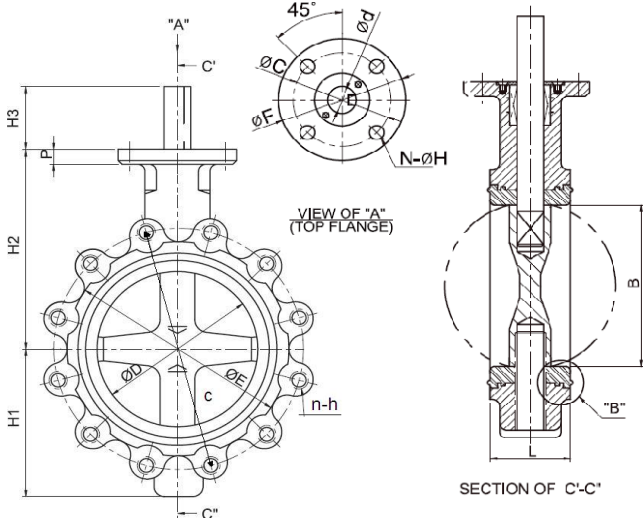

Standard Specification		
Face to Face dimension	ISO5752 (20#), JIS B2002 46#	
Body design	Lug Type	
Valve Size	50-300 350-500	
Top flange	ISO5211	
Flange Standard	5K/10K, 150lb, PN10 PN16	
Max.Working Pressure	1.0 Mpa	
Working temp.	NBR:-10-80°C, EPDM:-20-120°C	
Material	Body	Ductile Iron, Cast Iron, Cast Steel
	Disc	SUS304(SCS13), SUS316(SCS14)
	Seat	NBR, EPDM, VITON
	Stem	SUS420J2, SUS416
Actuators	lock lever	50-200 -
	Worm gear	✓ ✓
	Centre handle	✓ ✓
	Pneumatic	✓ ✓
	Motorized	✓ ✓

Flange Drilling Table

(unit : mm)

SIZE	PN 10			PN 16			ANSI 150 LBS			JIS 5K			JIS 10K		
	mm	c	n	h	c	n	h	c	n	h	c	n	h	c	n
50A	125.0	4	M16	125.0	4	M16	120.7	4	5/8"	105.0	4	M12	120.0	4	M16
65A	145.0	4	M16	145.0	4	M16	139.7	4	5/8"	130.0	4	M12	140.0	4	M16
80A	160.0	8	M16	160.0	8	M16	152.4	4	5/8"	145.0	4	M16	150.0	8	M16
100A	180.0	8	M16	180.0	8	M16	190.5	8	5/8"	165.0	8	M16	175.0	8	M16
125A	210.0	8	M16	210.0	8	M16	215.9	8	3/4"	200.0	8	M16	210.0	8	M20
150A	240.0	8	M20	240.0	8	M20	241.3	8	3/4"	230.0	8	M16	240.0	8	M20
200A	295.0	8	M20	295.0	12	M20	298.5	8	3/4"	280.0	8	M20	290.0	12	M20
250A	350.0	12	M20	355.0	12	M24	362.0	12	7/8"	345.0	12	M20	355.0	12	M22
300A	400.0	12	M20	410.0	12	M24	431.8	12	7/8"	390.0	12	M20	400.0	16	M22
350A	460.0	16	M20	470.0	16	M24	476.3	12	1"	435.0	12	M22	445.0	16	M22
400A	515.0	16	M24	525.0	16	M27	539.8	16	1"	495.0	16	M22	510.0	16	M24
450A	565.0	20	M24	585.0	20	M27	577.9	16	1 1/8"	555.0	16	M22	565.0	20	M24
500A	620.0	20	M24	650.0	20	M30	635.0	20	1 1/8"	605.0	20	M22	620.0	20	M24

Dimensions

(unit : mm)

SIZE	TOP FLANGE & STEM									OUT LINE DIMENSION					
	mm	Ød	P	ØC	N	H	T	ØF	H3	ISO 5211	L	ØD	H1	H2	ØE
50A	14.0	14	70	4	9	11	90	15.2	F07	43.0	52.0	75.0	130.0	93	49.0
65A	14.0	14	70	4	9	11	90	15.2	F07	46.0	67.0	80.0	137.0	108	64.0
80A	14.0	14	70	4	9	11	90	15.2	F07	46.0	80.0	84.0	156.0	122	77.0
100A	16.0	16	70	4	9	14	90	17.7	F07	52.0	100.0	110.0	170.0	150	97.0
125A	18.0	16	70	4	9	14	90	17.7	F07	56.0	125.0	123.0	185.0	180	122.0
150A	18.0	16	70	4	9	14	90	17.7	F07	56.0	150.5	143.0	203.0	208	148.0
200A	22.0	17	70	4	9	17	90	20.5	F07	60.0	196.5	168.0	238.0	259	193.5
250A	25.4	20	102	4	11	22	125	20.5	F10	68.0	247.0	203.0	270.0	318	244.4
300A	28.0	20	102	4	11	22	125	24.1	F10	78.0	295.5	242.0	310.0	370	293.0
350A	28.0	20	102	4	12		125	70.0	F10	78.0	330.0	264.5	345.5	415	326.0
400A	32.0	23	140	4	18		175	80.0	F14	102.0	379.0	298.5	349.5	468	376.5
450A	38.0	23	140	4	18		175	80.0	F14	114.0	437.0	350.0	400.0	527	434.0
500A	45.0	23	165	4	22		210	90.0	F16	127.0	490.0	380.0	440.0	578	486.0

BUTTERFLY VALVE

JIS Butterfly valve-Semi Lug type

Face To Face - ISO5752-Series 20, JIS B2002 46

F7480 5K&10K, PN10&PN16, Class150

Manufactured in accordance to JIS F7480

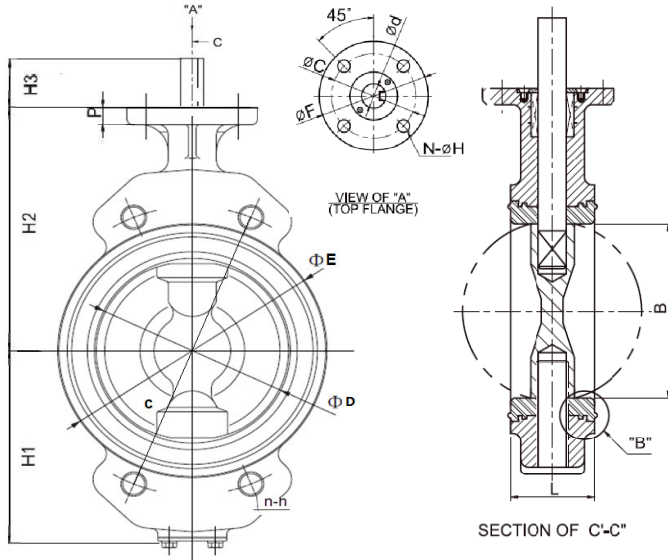

Standard Specification		
Face to Face dimension	ISO5752 (20#), JIS B2002 46#	
Body design	Semi Lug Type	
Valve Size	50-300 350-500	
Top flange	ISO5211	
Flange Standard	5K/10K, 150lb, PN10 PN16	
Max.Working Pressure	1.0 Mpa	
Working temp.	NBR:-10-80℃, EPDM:-20-120℃	
Material	Body	Ductile Iron, Cast Iron, Cast Steel
	Disc	SUS304(SCS13), SUS316(SCS14)
	Seat	NBR, EPDM, VITON
	Stem	SUS420J2, SUS416
Acutators	lock lever	50-200
	Worm gear	✓ ✓
	Centre handle	✓ ✓
	Pneumatic	✓ ✓
	Motorized	✓ ✓

(unit : mm)

Dimensions

SIZE	TOP FLANGE & STEM									OUT LINE DIMENSION					
	Ød	P	ØC	N	H	T	ØF	H3	ISO 5211	L	ØD	H1	H2	ØE	B
50A	14.0	14	70	4	9	11	90	15.2	F07	43.0	52.0	75.0	130.0	93	49.0
65A	14.0	14	70	4	9	11	90	15.2	F07	46.0	67.0	80.0	137.0	108	64.0
80A	14.0	14	70	4	9	11	90	15.2	F07	46.0	80.0	84.0	156.0	122	77.0
100A	16.0	16	70	4	9	14	90	17.7	F07	52.0	100.0	110.0	170.0	150	97.0
125A	18.0	16	70	4	9	14	90	17.7	F07	56.0	125.0	123.0	185.0	180	122.0
150A	18.0	16	70	4	9	14	90	17.7	F07	56.0	150.5	143.0	203.0	208	148.0
200A	22.0	17	70	4	9	17	90	20.5	F07	60.0	196.5	168.0	238.0	259	193.5
250A	25.4	20	102	4	11	22	125	20.5	F10	68.0	247.0	203.0	270.0	318	244.4
300A	28.0	20	102	4	11	22	125	24.1	F10	78.0	295.5	242.0	310.0	370	293.0
350A	28.0	20	102	4	12		125	70.0	F10	78.0	330.0	264.5	345.5	415	326.0
400A	32.0	23	140	4	18		175	80.0	F14	102.0	379.0	298.5	349.5	468	376.5
450A	38.0	23	140	4	18		175	80.0	F14	114.0	437.0	350.0	400.0	527	434.0
500A	45.0	23	165	4	22		210	90.0	F16	127.0	490.0	380.0	440.0	578	486.0

Flange Drilling Table

(unit : mm)

SIZE	PN 10			PN 16			ANSI 150 LBS			JIS 5K			JIS 10K		
	c	n	h	c	n	h	c	n	h	c	n	h	c	n	h
50A	125.0	4	M16	125.0	4	M16	120.7	4	5/8"	105.0	4	M12	120.0	4	M16
65A	145.0	4	M16	145.0	4	M16	139.7	4	5/8"	130.0	4	M12	140.0	4	M16
80A	160.0	8	M16	160.0	8	M16	152.4	4	5/8"	145.0	4	M16	150.0	8	M16
100A	180.0	8	M16	180.0	8	M16	190.5	8	5/8"	165.0	8	M16	175.0	8	M16
125A	210.0	8	M16	210.0	8	M16	215.9	8	3/4"	200.0	8	M16	210.0	8	M20
150A	240.0	8	M20	240.0	8	M20	241.3	8	3/4"	230.0	8	M16	240.0	8	M20
200A	295.0	8	M20	295.0	12	M20	298.5	8	3/4"	280.0	8	M20	290.0	12	M20
250A	350.0	12	M20	355.0	12	M24	362.0	12	7/8"	345.0	12	M20	355.0	12	M22
300A	400.0	12	M20	410.0	12	M24	431.8	12	7/8"	390.0	12	M20	400.0	16	M22
350A	460.0	16	M20	470.0	16	M24	476.3	12	1"	435.0	12	M22	445.0	16	M22
400A	515.0	16	M24	525.0	16	M27	539.8	16	1"	495.0	16	M22	510.0	16	M24
450A	565.0	20	M24	585.0	20	M27	577.9	16	1 1/8"	555.0	16	M22	565.0	20	M24
500A	620.0	20	M24	650.0	20	M30	635.0	20	1 1/8"	605.0	20	M22	620.0	20	M24

BUTTERFLY VALVE

JIS Butterfly valve-Double Flanged Type

Face To Face - ISO5752-Series 20 (JIS B2002 46#)

F7480 5K&10K, PN10&PN16, Class150

Manufactured in accordance to JIS F7480

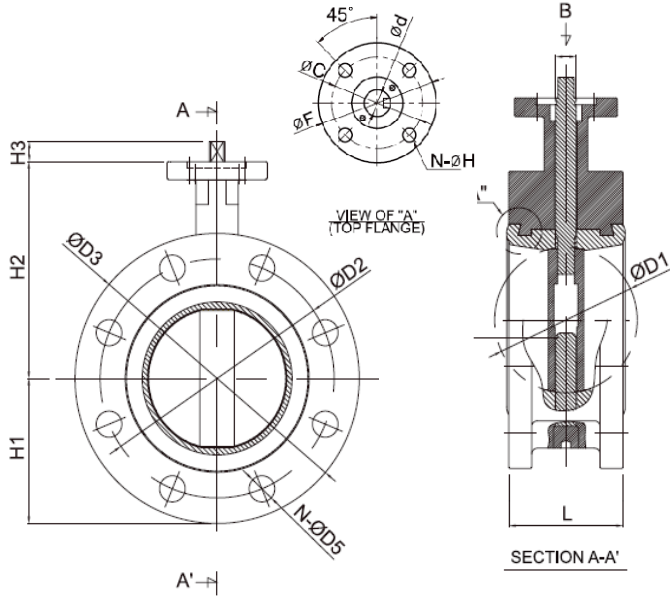

Standard Specification		
Face to Face dimension	ISO5752 (20#), JIS B2002 46#	
Body design	Double Flanged Type	
Valve Size	50-300	
Top flange	ISO5211	
Flange Standard	5K/10K, 150lb, PN10 PN16	
Max.Working Pressure	1.0 Mpa	
Working temp.	NBR:-10-80℃, EPDM:-20-120℃	
Material	Body	Ductile Iron, Cast Iron, Cast Steel
	Disc	SUS304(SCS13), SUS316(SCS14)
	Seat	NBR, EPDM, VITON
	Stem	SUS420J2, SUS416
Actuators	lock lever	50-200
	Worm gear	✓
	Centre handle	✓
	Pneumatic	✓
	Motorized	✓

Dimensions

(unit : mm)

SIZE	TOP FLANGE & STEM								OUTLINE DIMENSION				
	H3	d0	X	G	F	n	H	ISO 5211	D3	D1	H1	H2	L
DN50	15.20	14.5	11.0	90	70	4	9	F07	165	52.0	82.50	133.00	43
DN65	15.20	14.5	11.0	90	70	4	9	F07	185	67.0	92.50	141.00	46
DN80	15.20	14.5	11.0	90	70	4	9	F07	200	80.0	100.00	145.00	46
DN100	17.70	16.5	14.0	90	70	4	9	F07	230	100.0	115.00	166.50	52
DN125	17.70	19.5	14.0	90	70	4	9	F07	270	125.0	135.00	190.50	56
DN150	17.70	19.5	14.0	90	70	4	9	F07	305	150.5	152.50	206.50	56
DN200	20.50	22.5	17.0	90	70	4	9	F07	350	196.5	175.00	240.00	60
DN250	20.50	25.9	22.0	125	102	4	11	F10	430	247.0	215.00	286.00	68
DN300	24.10	28.5	22.0	125	102	4	11	F10	485	295.5	242.50	313.00	78

Flange Drilling Table

(unit : mm)

SIZE	PN10			PN16			ANSI 150 LBS			JIS 5K			JIS 10K			JIS 16K		
	ØD2	N	ØD5	ØD2	N	ØD5	ØD2	N	ØD5	ØD2	N	ØD5	ØD2	N	ØD5	ØD2	N	ØD5
50A	125	4	18	125	4	18	120.7	4	19.1	105	4	15	120	4	19	120	8	19
65A	145	4	18	145	4	18	139.7	4	19.1	130	4	15	140	4	19	140	8	19
80A	160	8	18	160	8	18	152.4	4	19.1	145	4	19	150	8	19	160	8	23
100A	180	8	18	180	8	18	190.5	8	19.1	165	8	19	175	8	19	185	8	23
125A	210	8	18	210	8	18	215.9	8	22.2	200	8	19	210	8	23	225	8	25
150A	240	8	22	240	8	22	241.3	8	22.2	230	8	19	240	8	23	260	12	25
200A	295	8	22	295	12	22	298.5	8	22.2	280	8	23	290	12	23	305	12	25
250A	350	12	22	355	12	26	362.0	12	25.4	345	12	23	355	12	25	380	12	27
300A	400	12	22	410	12	26	431.8	12	25.4	390	12	23	400	16	25	430	16	27

BUTTERFLY VALVE

JIS Butterfly valve-Double Flanged Type

Face To Face -JIS B2002 122#

F7480 5K&10K, PN10&PN16, Class150

Manufactured in accordance to JIS F7480

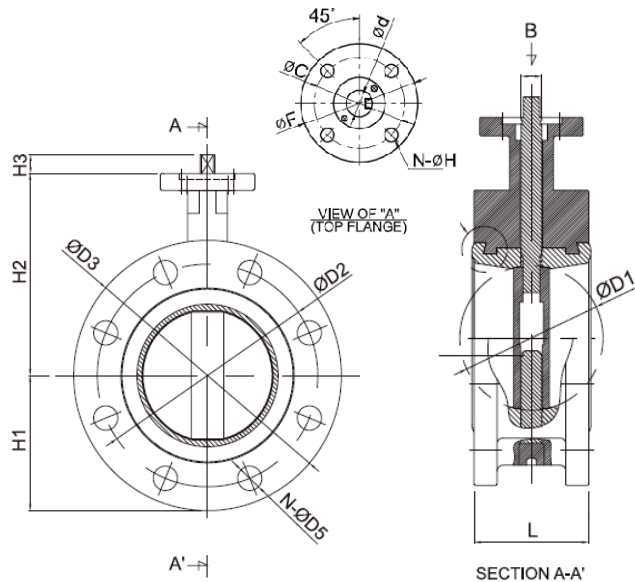

Standard Specification		
Face to Face dimension	JIS B2002 122#	
Body design	Double Flanged Type	
Valve Size	50-300	350-600
Top flange	ISO5211	
Flange Standard	5K/10K, 150lb, PN10 PN16	
Max.Working Pressure	1.0 Mpa	
Working temp.	NBR:-10-80°C, EPDM:-20-120°C	
Material	Body	Ductile Iron, Cast Iron, Cast Steel
	Disc	SUS304(SCS13), SUS316(SCS14)
	Seat	NBR, EPDM
	Stem	SUS420J2, SUS416
Actuators	lock lever	50-200
	Worm gear	✓
	Centre handle	✓
	Pneumatic	✓
	Motorized	✓

Dimensions

(unit : mm)

SIZE	OUTLINE DIMENSION					TOP FLANGE & STEM								
	MM	D1	D3	H1	H2	L	H	D4	Ød	H3	F	G	n	X
DN 125	125.0	255	127.50	190.50	100	9	53	18.0	17.70	70	90	4	14	F07
DN 150	150.5	285	143.00	206.50	100	9	53	18.0	17.70	70	90	4	14	F07
DN 200	196.5	345	172.50	240.00	100	9	58	22.0	20.50	70	90	4	17	F07
DN 250	247.0	405	203.00	286.00	110	11	58	25.4	20.50	102	125	4	22	F10
DN 300	295.5	485	242.50	313.00	110	11	68	28.0	24.10	102	125	4	22	F10
DN 350	330.0	535	267.50	345.50	120	12	68	28.0	70.00	102	125	4	-	F10
DN 400	379.0	595	298.50	390.50	130	18	80	32.0	80.00	140	175	4	-	F14
DN 450	437.0	640	350.00	413.00	150	18	80	38.0	80.00	140	175	4	-	F14
DN 500	490.0	715	380.00	460.50	160	22	90	45.0	90.00	165	210	4	-	F16
DN 600	574.5	840	440.00	523.00	170	22	105	55.0	95.00	165	210	4	-	F16

Flange Drilling Table

(unit : mm / inch)

SIZE		JIS 10K			JIS 5K			ANSI150			PN 10			PN 16		
mm	inch	ØD2	N	ØD5	ØD2	N	ØD5	ØD2	N	ØD5	ØD2	N	ØD5	ØD2	N	ØD5
DN125	5"	210	8	Ø23(M20)	200	8	Ø19(M16)	215.9	8	7/8"(3/4")	210	8	Ø18(M16)	210	8	Ø18(M16)
DN150	6"	240	8	Ø23(M20)	230	8	Ø19(M16)	241.3	8	7/8"(3/4")	240	8	Ø22(M20)	240	8	Ø22(M20)
DN200	8"	290	12	Ø23(M20)	280	8	Ø23(M20)	298.5	8	7/8"(3/4")	295	8	Ø22(M20)	295	12	Ø22(M20)
DN250	10"	355	12	Ø25(M22)	345	12	Ø23(M20)	362.0	12	1"(7/8")	350	12	Ø22(M20)	355	12	Ø26(M24)
DN300	12"	400	16	Ø25(M22)	390	12	Ø23(M20)	431.8	12	1"(7/8")	400	12	Ø22(M20)	410	12	Ø26(M24)
DN350	14"	445	16	Ø25(M22)	435	12	Ø25(M22)	476.3	12	1 1/8"(1")	460	16	Ø22(M20)	470	16	Ø26(M24)
DN400	16"	510	16	Ø27(M24)	495	16	Ø25(M22)	539.8	16	1 1/8"(1")	515	16	Ø26(M24)	525	16	Ø30(M27)
DN450	18"	565	20	Ø27(M24)	555	16	Ø25(M22)	577.9	16	1 1/4"(1 1/8")	565	20	Ø26(M24)	585	20	Ø30(M27)
DN500	20"	620	20	Ø27(M24)	605	20	Ø25(M22)	635.0	20	1 1/4"(1 1/8")	620	20	Ø26(M24)	650	20	Ø33(M30)
DN600	24"	730	24	Ø33(M30)	715	20	Ø27(M24)	749.3	20	1 3/8"(1 1/4")	725	20	Ø30(M27)	770	20	Ø36(M33)